

**PROJECT:**  
**CHERRY LANE ROAD IMPROVEMENT**

**PROPOSAL**

**LOGAN COUNTY  
BOARD OF COMMISSIONERS**

Joe Antram  
Michael Yoder  
Mark Robinson

**Letting – Tuesday, May 16, 2023, at 10:15 AM**

Company \_\_\_\_\_

Submitted by \_\_\_\_\_

Street \_\_\_\_\_

Post Office \_\_\_\_\_

City \_\_\_\_\_

State \_\_\_\_\_ Zip \_\_\_\_\_

Telephone \_\_\_\_\_

LEGAL NOTICE TO BIDDERS

Notice is hereby given that bids will be received in a sealed envelope at the office of the Logan County Commissioners, 117 E. Columbus Avenue, Suite 100, Bellefontaine, Ohio, 43311, on Tuesday, May 16, 2023 at 10:15 AM, for the CHERRY LANE ROAD IMPROVEMENT.

Bidders must submit a bid guaranty as specified in R.C. 153.54.

The Legal Notice to Bidders and Bid Package is posted on the Logan County Engineer's web page at: [http://www.lceo.us/Bid\\_Documents/index.html](http://www.lceo.us/Bid_Documents/index.html)

By order of the  
Logan County Commissioners

DeDe Doss, Clerk/Admin.

Posted: May 2, 2023

Advertised: May 2 and May 9, 2023

## **OHIO REVISED CODE**

### **SECTION 3517.13(I)**

Ohio Revised Code Section 3517.13(I) requires that no agency or department of this state or any political subdivision shall award any contract, other than one let by competitive bidding or a contract incidental to such contract or which is by force account, for the purchase of goods costing more than five hundred dollars or services costing more than five hundred dollars to any individual, partnership, association, including, without limitation, a professional association organized under Chapter 1785 of the ORC, estate, or trust if the individual has made or the individual's spouse has made, or any partner, shareholder, administrator, executor, or trustee or the spouse of any of them has made, as an individual, within the two previous calendar years, one or more contributions totaling in excess of one thousand dollars to the holder of the public office having ultimate responsibility for the award of the contract or to the public officer's campaign committee. Furthermore, Ohio Revised Code Section 3517.13(J) requires that no agency or department of this state or any political subdivision shall award any contract, other than one let by competitive bidding or a contract incidental to such contract or which is by force account, for the purchase of goods costing more than five hundred dollars or services costing more than five hundred dollars to a corporation or business trust, except a professional association organized under Chapter 1785 of the ORC, if an owner of more than twenty per cent of the corporation or business trust or the spouse of that person has made, as an individual, within the two previous calendar years, taking into consideration only owners for all of that period, one or more contributions totaling in excess of one thousand dollars to the holder of a public office having ultimate responsibility for the award of the contract or to the public officer's campaign committee.

### **NON -COLLUSION AFFIDAVIT**

In accordance with Title 23 United States Code, Section 112 and Ohio Revised Code, Chapter 1331 et. seq: and Sections 2921.11 and 2921.13, the bidder hereby states, under penalty of perjury and under other such penalties as the law provides, that he or his agents or employees have not entered either directly or indirectly into any agreement, participated in any collusion, or otherwise taken any action in restraint of free competitive bidding in connection with this proposal. Execution of this proposal on the signature portion thereof shall constitute also signature of this Non-Collusion Affidavit

### **CAMPAIGN CONTRIBUTIONS AFFIDAVIT**

Ohio Revised Code Section 3517.13(I) requires that no agency or department of this state or any political subdivision shall award any contract, other than one let by competitive bidding or a contract incidental to such contract or which is by force account, for the purchase of goods costing more than five hundred dollars or services costing more than five hundred dollars to any individual, partnership, association, including, without limitation, a professional association organized under Chapter 1785 of the ORC, estate, or trust if the individual has made or the individual's spouse has made, or any partner, shareholder, administrator, executor, or trustee or the spouse of any of them has made, as an individual, within the two previous calendar years, one or more contributions totaling in excess of one thousand dollars to the holder of the public office having ultimate responsibility for the award of the contract or to the public officer's campaign committee. Furthermore, Ohio Revised Code Section 3517.13(J) requires that no agency or

department of this state or any political subdivision shall award any contract, other than one let by competitive bidding or a contract incidental to such contract or which is by force account, for the purchase of goods costing more than five hundred dollars or services costing more than five hundred dollars to a corporation or business trust, except a professional association organized under Chapter 1785 of the ORC, if an owner of more than twenty per cent of the corporation or business trust or the spouse of that person has made, as an individual, within the two previous calendar years, taking into consideration only owners for all of that period, one or more contributions totaling in excess of one thousand dollars to the holder of a public office having ultimate responsibility for the award of the contract or to the public officer's campaign committee. Execution of this proposal on the signature portion thereof shall constitute also signature of this Campaign Contributions Affidavit.

**COMPETITIVE BIDDER'S  
PERSONAL PROPERTY TAX AFFIDAVIT  
LOGAN COUNTY, OHIO (R.C. 5719.042)**

STATE OF OHIO:

: ss:

LOGAN COUNTY :

The undersigned, being duly sworn, says that he is or represents a competitive bidder doing business in, or with Logan County, Ohio, and that: (Check appropriate lines)

\_\_\_\_\_ He is a sole proprietorship doing business under his own name.

\_\_\_\_\_ He is a sole proprietorship doing business under the name of \_\_\_\_\_

\_\_\_\_\_ He is a general partner of the partnership known as \_\_\_\_\_

\_\_\_\_\_ He is a duly authorized officer of the corporation named \_\_\_\_\_

The business address of the bidder is \_\_\_\_\_

\_\_\_\_\_ ; Telephone \_\_\_\_\_

The undersigned further says that the bidder at the time of submitting his or its bid:

\_\_\_\_\_ Was not charged with any delinquent personal taxes in Logan County, Ohio.

\_\_\_\_\_ Was charged with delinquent personal property taxes as follows:

YEAR	AMOUNT	PENALTY	INTEREST
20_____	\$_____	\$_____	\$_____
20_____	\$_____	\$_____	\$_____
20_____	\$_____	\$_____	\$_____

Signed: \_\_\_\_\_

Title: \_\_\_\_\_

STATE OF OHIO:

: ss:

LOGAN COUNTY :

Before me, a notary, in and for said county, personally appeared

\_\_\_\_\_ (sole proprietor doing business under his own name)

(sole proprietor doing business under the name of \_\_\_\_\_)

(general partner of the Partnership known as \_\_\_\_\_)

(duly authorized officer of the Corporation name \_\_\_\_\_),

who acknowledged that he is authorized in the premises and that his signing of this instrument is the free act and deed of himself or the organization which he represents.

In testimony whereof, I have hereunto subscribed my name and affixed my official seal at

\_\_\_\_\_, Ohio, this \_\_\_\_\_ day of \_\_\_\_\_, 2\_\_\_\_\_.

\_\_\_\_\_  
Notary Public

COMMISSIONERS:

\_\_\_\_\_ No delinquent taxes - file

\_\_\_\_\_ Delinquent taxes - sent to County Engineer

\_\_\_\_\_  
Clerk

**WRITTEN CONTRACT**

On acceptance of the proposal for said work \_\_\_\_\_do hereby bind myself or ourselves this \_\_\_\_\_ day of \_\_\_\_\_, 2021, to enter into a written contract with the Logan County Commissioners within ten (10) days from date of notice of award.

**IF AN INDIVIDUAL, SIGN BELOW**

Name\_\_\_\_\_ Address\_\_\_\_\_

Telephone\_\_\_\_\_

**IF AN INDIVIDUAL DOING BUSINESS UNDER A TRADE NAME, SIGN BELOW:**

Name\_\_\_\_\_ Address\_\_\_\_\_

Sole Owner\_\_\_\_\_ Telephone\_\_\_\_\_

**IF A PARTNERSHIP, SIGN BELOW:**

Name\_\_\_\_\_ Address\_\_\_\_\_

By\_\_\_\_\_ Telephone\_\_\_\_\_

Partner\_\_\_\_\_ Address\_\_\_\_\_

Partner\_\_\_\_\_ Address\_\_\_\_\_

Partner\_\_\_\_\_ Address\_\_\_\_\_

**IF A CORPORATION, SIGN BELOW:**

Incorporated under the laws of the State of \_\_\_\_\_

Name of Corporation\_\_\_\_\_

Address\_\_\_\_\_

Telephone\_\_\_\_\_

By\_\_\_\_\_

Title of Officer Signing

## **INSTRUCTIONS TO BIDDERS**

**SUBMITTAL OF BIDS** Bids shall be submitted on forms furnished by the Logan County Engineer's Office in a sealed envelope marked 'CHERRY LANE ROAD IMPROVEMENT' on the outside. Sealed bids shall be submitted to the Logan County Commissioner's Office at the address listed in the Legal Notice.

**DATE, TIME, FORM OF PROPOSAL, AND PLACE FOR OPENING:** Pursuant to the Legal Notice to Bidders, at the date, time and place set forth in said notice, sealed proposals will be publicly opened by the Board of Logan County Commissioners and read aloud; the awarding of the contract, if awarded, will be made by the Board of Logan County Commissioners within thirty (30) days after the opening of the proposals.

**OMISSIONS AND DISCREPANCIES:** Should a bidder find discrepancies in, or omissions from the drawings or other contract documents, or should be in doubt as to their meaning, they shall at once notify the Logan County Engineer's Designee, Michael Kerns, who may send a written instruction to all bidders.

**ACCEPTANCE OR REJECTION OF PROPOSALS:** Logan County reserves the right to reject any or all proposals. Without limiting the generality of the foregoing, any proposal which is incomplete, obscure, or irregular may be rejected; any proposal in which unit prices are omitted or in which unit prices are unbalanced, may be rejected; any proposal accompanied by an insufficient or irregular bid guarantee may be rejected.

**BID GUARANTEE AND PERFORMANCE BOND:** As specified in R.C. 153.54, a bidder must submit a bid guaranty in the form of either:

- (1) a bond for the full amount of the bid, or
- (2) a certified check, cashier's check, or letter of credit in the amount of 10% of the bid.

**ACCEPTANCE OF PROPOSAL:** Within thirty (30) days after the opening of proposals, the Board of County Commissioners will act upon them. The acceptance of a proposal shall bind the successful bidder to execute the contract, and to be responsible for liquidated damages as provided herein. The rights and obligations provided for in the contract shall become effective and binding upon the parties only with its formal execution by the Board of Logan County Commissioners.

**AMERICANS WITH DISABILITIES ACT OF 1990** Bidders shall comply with the provisions of the Americans with Disabilities Act of 1990.

**DAMAGES FOR FAILURE TO EXECUTE CONTRACT:** Any bidder whose proposal is accepted will be required to execute the contract within ten (10) days after the notice that the contract has been awarded to them. Failure or neglect to do so shall constitute a breach of the agreement affected by the acceptance of the proposal.



**COMPETITIVE BIDDER'S PERSONAL PROPERTY TAX AFFIDAVIT:** All bidders must complete and attach this affidavit to each bid proposal. The amount of the bid guarantee, as specified in Sections 153.54 (B), (C), (D) and (E) of the Ohio Revised Code, accompanying the proposal shall be retained by Logan County as liquidated damages for such breach.

**COMPLETION DATE: October 1, 2023**

**BIDDER PREQUALIFICATIONS** Bidders must be ODOT Pre-Qualified: “Work Type 10 - Flexible Paving” and shall be pre-qualified at the time of bidding, at the time of award and through the life of the construction contract.

**PRICES:** Bids shall have separate unit prices for all items. The prices are to include the furnishing of all equipment, materials, plant, tools, and all other facilities, and the performance of all labor and services necessary or proper for the completion of the work, except as may be otherwise expressly provided in the contract documents.

**INTERPRETATIONS AND ADDENDA:** No oral interpretations shall be made to any bidder as to the meaning of any of the contract documents, or be effective to modify any of the contract documents. Every request for an interpretation shall be made using the electronic bidding platform via the Bid Express website.

**AWARD OF BID** Bids will be awarded to the lowest and best bidder, based on the grand total. The Board of Commissioners reserves the right to reject any or all bids and to waive any defects in the bids.

## GENERAL CONDITIONS

1. The contract documents are complementary, and what is called for by any one shall be binding as if called for by all. The intention of the documents is to include all labor and materials, equipment and transportation necessary for the completion of the work. Materials or work described in words which so applied have a well known technical or trade meaning shall be held to such standards.

The State of Ohio Department of Transportation Construction and Material Specifications as revised January 1, 2019 shall govern all items on this project except as modified in the **INSTRUCTION TO BIDDERS, GENERAL CONDITIONS, GENERAL NOTES, or in the PLANS.**

2. The following Definitions and Terms refer to the State of Ohio Department of Transportation Construction and Materials Specifications.

a) The State: Whenever the term "The State" appears in the specifications it shall be changed to mean Logan County, acting through its authorized representatives.

b) Department: Whenever the term "The Department" appears on the specifications it shall be changed to mean the office of the Logan County Engineer.

c) Director: Whenever the term "The Director" appears in the specifications it shall be changed to mean the Logan County Engineer.

The Engineer: Whenever the word "Engineer" appears in the Contract Documents or specifications it shall mean the Logan County Engineer or the duly authorized representative.

e) The Laboratory: Whenever the word "Laboratory" appears in the Contract Documents or Specifications it shall mean an independent testing consultant in the employ of the County to provide testing for this project.

3. The Engineer shall furnish to the Contractor free of charge, electronic versions of drawings and specifications necessary for the execution of the work.

4. The Contractor shall provide and pay for all materials, labor, water, tools, equipment, lights, power, transportation, and other facilities necessary for the execution, and completion of the work. All materials shall be new and both workmanship and materials shall be of good quality. The Contractor shall, if required, furnish satisfactory evidence of the quality and kind of materials.

The Contractor shall at all times enforce strict discipline and good order among employees, and shall not employ to work any unfit person or anyone not skilled in the work assigned.

5. The Contractor shall pay all royalties and license fees. The Contractor shall defend all suits and claims for infringements of any patent rights and shall save the County harmless from loss on account thereof.

6. Permits and licenses of a temporary nature necessary for the prosecution of the work shall be secured by the Contractor. The Contractor shall give all notices and comply with all laws, ordinances, rules, and regulations bearing on the conduct of the work as drawn and specified. If the Contractor observes that the drawings and specifications are at variance therewith, the Contractor shall promptly notify the Engineer, and any necessary change shall be adjusted as provided in the Contract for Changes in the work.

7. The Contractor shall continuously maintain adequate protection on all work from damage. The Contractor shall make good such damage, injury, or loss, except as may be due to errors in the Contract Documents. The Contractor shall adequately protect adjacent property. The Contractor shall provide and maintain all passage ways, barricades, lights, and other facilities for protection required by public authority or local conditions.

In an emergency affecting the safety of life or of the work or adjoining property, the Contractor, without special instructions or authorization from the Engineer, is hereby permitted to act, at their discretion, to prevent such threatened loss or injury, and they shall so act, without appeal, if so instructed and authorized.

8. The Engineer shall at all times have access to the work. If the specifications, the Engineer's instructions, or any public authority require any work to be specially tested or approved, the Contractor shall give the Engineer timely notice of its readiness for inspection. If any work should be covered up without approval or consent of the Engineer, it must, if required by the Engineer, be uncovered for examination at the Contractor's expense.

9. The Contractor shall at all times keep a satisfactory superintendent on the work, who shall represent the Contractor in their absence and all directions given shall be as binding as if given to the Contractor.

10. The County, without invalidating the Contract, subject to Section 5555.69 O.R.C., may order work or make changes by altering, adding to or deducting from the work, the Contract Amount being adjusted accordingly. All such work shall be executed under the conditions of the original contract except that any claim for extension of time caused thereby shall be adjusted at the time of ordering such change.

Except in emergency endangering life or property, no extra work or change shall be made unless in pursuance of a written order by the Engineer and no claim for an addition to the Contract Amount shall be valid unless so ordered.

The value of any such extra work or change shall be determined by estimate and acceptance in a lump sum or by unit prices named in the contract or subsequently agreed upon.

If the Engineer deems it expedient to correct work injured or not done in accordance with the Contract Documents, an equitable deduction from the Contract Amount shall be made there from.

11. If the Contractor should be adjudged a bankrupt, or be in any manner financially insolvent, or if the Contractor should refuse or fail to supply properly skilled workmen or proper materials or otherwise be guilty of a substantial violation of the terms of this Contract then the County, upon written certification by the Engineer that sufficient cause exists to justify such

action may without prejudice to any other remedy and after giving the Contractor seven (7) days notice, terminate the employment of the Contractor and take possession of all tools, appliances, and materials thereon, and finish the work by whatever method deem expedient. In such case, the Contractor shall not be entitled to receive further payment until the work is finished.

If the unpaid balance in the Contract Price shall exceed the expense of finishing the work including compensation for additional managerial services, such excess shall be paid to the Contractor. If such expense shall exceed such unpaid balance, the Contractor shall pay the difference to the County.

12. If the Contractor should neglect to prosecute the work properly or fail to perform any provision of the Contract, the County, after three (3) days written notice to the Contractor, may without prejudice to any other remedy it may have, make good such deficiencies and may deduct the cost thereof from the payment then or thereafter due the Contractor.

13. If the work should be stopped under an order of any court or other public authority for a period of three (3) months through no act or fault of the Contractor or of anyone employed by the Contractor, or if the Engineer should fail to issue any estimate within fourteen (14) days after it is due, or if the County should fail to pay the Contractor within fourteen (14) days of its maturity and presentation, any sum certified by the Engineer or awarded by arbitrators, then the Contractor may, upon seven (7) days written notice, terminate the Contract and recover from the County payment for all work executed and any loss sustained upon any materials and reasonable profit.

14. The County may withhold or, on account of subsequently discovered evidence, nullify the whole or a part of any certificate to such extent as may be necessary to protect itself from loss on account of:

- (A) Defective work not remedied.
- (B) Claims filed or evidence indicating probable filing.
- (C) Failure of the Contractor to pay bills.
- (D) Doubt that the Contract can be completed for the balance then unpaid.

When above grounds are removed payment shall be made for amounts withheld on account of them.

15. The Contractor shall indemnify and save harmless the County from and against all losses and all claims, demands, payments, suits, actions, recoveries and judgments of every nature and description brought or recovered against the County, by reason or any act or omission of the said Contractor, agents or employees, in the execution of the work or in the guarding of it.

The Contractor shall maintain workers' compensation coverage as required by Ohio law.

17. The Contractor shall not assign the contract or sublet it as a whole without the written consent of the County.

18. The Contractor shall carefully preserve bench marks, reference points and stakes, and in case of willful or careless destruction, they shall be charged with the resulting expense.

19. The Engineer shall have general supervision and direction of the work. The Engineer

has authority to stop the work whenever such stoppage may be necessary to insure the proper execution of the Contract. The Engineer shall also have the authority to reject all work and materials which do not conform to the Contract, to direct the application of forces to any part of the work, to order the force increased or diminished, and to decide questions which arise in the execution of the work.

20. The Contractor shall, as directed by the Engineer, remove from public and private property, at the Contractor expense, all temporary structures, rubbish and waste materials resulting from contract operations.

21. The Contractor will be expected to pay the State prevailing minimum wage to all labor employed on this project as ascertained and determined for Logan County, Ohio.

22. For each calendar day that any work shall remain uncompleted after the contract completion date, the liquidated damages, as described in 108 of the State of Ohio, Department of Highway's Materials and Specifications, dated January 1, 2019 may be imposed.

23. The Contractor will comply with Sections 153.59 and 153.30 O.R.C., Discrimination and Intimidation on Account of Race, Creed, or Color, and Forfeiture, when performing the work on this project.

24. Logan County and the Logan County Engineer will not waive subrogation rights.

25. The Contractor shall maintain commercial general liability insurance with a limit of not less than \$1,000,000 each occurrence. The County, its elected officials and employees, shall be named as additional insured's with respect to all activities under this agreement.

26. The Contractor shall maintain automobile liability insurance with a limit of not less than \$1,000,000 each incident. Such insurance shall include coverage for owned, hired, and non-owned automobiles.

27. Prior to the commencement of any work under this agreement, the Contractor shall furnish the County with properly executed certificates of insurance for all insurance required by this agreement. Certificates of insurance shall provide that such insurance shall not be cancelled without 30 days prior written notice to the County. The Contractor will replace certificates for any insurance expiring prior to completion of work under this agreement.

## GENERAL NOTES

**Mobilization and Bonding:** The Contractor shall fulfill the mobilization requirements detailed in Sections 624.01, 624.02 and 624.03 of the State of Ohio Department of Transportation Construction and Material Specifications. Payment for this work shall be included in the unit cost for all of the bid items for the proposed work. The Contractor shall also include the cost of the bonding requirements in these items.

**Item 201 Clearing and Grubbing:** The contractor shall remove all trees, bushes and stumps located within the right-of-way (1) when said items need removed to accomplish the project and the Engineer agrees that said items need removed and/or (2) when marked on the Plans.

**Item 202 – Removal of structures and obstructions:** This work consists of removing, hauling and disposing of existing drainage pipes and various structures (1) when said items need removed to accomplish the project and the Engineer agrees that said items need removed and/or (2) when not designated or permitted to remain as specified in the Plans.

**Item 203 Excavation & Embankment:** Quantities for this item reflect the lines shown on the cross sections. It's the intent of these plans to reuse portions of the existing stone that comprises the existing roadway; the Engineer will determine whether said material is suitable to be reused. Excavation in excess of the specified width and depth shall be backfilled with Item 304 at no cost to the Engineer. Item 203 includes furnishing and placing a minimum of 4" of topsoil per the plan cross sections.

**Item 209 Linear Grading:** The contractor shall construct the shoulders and ditch foreslopes by grading the excavated material according to the plan cross sections and to provide positive drainage to the roadside ditch. Any remaining or unsuitable material shall be hauled offsite. The requirements for compaction of Item 203 shall apply. Stationing of linear grading shall be measured along each edge of pavement.

**Item 304 Aggregate Base:** It is the intent of these plans to allow, when allowed per the cross sections and the Engineer's approval, portions of the existing aggregate roadway to serve as the aggregate base. If site excavations reveal an aggregate base that the Engineer does not deem structurally suitable as an aggregate base, Item 304 will be placed and paid per the bid unit cost. Once the new aggregate base has been installed, grade the entire width of the roadway cross section to a uniform surface before placement of Item 402. Per the Plans, a quantity of Item 304 has been provided to reconstruct driveways to meet the new edge of pavement.

**Item 404:** Per the plans, this item includes quantities for two driveways. Said driveways are to be installed per the Logan County Technical Design Standards Drawing B-15.

**Item 411 Crushed Berm Aggregate:** Complete all shoulder reconditioning as soon as possible or within 7 calendar days following placement of surface course or any course that results in a drop-off of 2 inches or greater. As needed or as directed by the Engineer, the Contractor shall deliver and place berm stone to driveways that cannot be laid with less than a 2 inch drop-off on the same day as the placing of the asphalt. Laying of additional asphalt or raking of existing drive aggregate may be adequate in lieu of immediately placing berm stone as approved by the Engineer or the Engineer designee. The Contractor shall perform compaction of the material using pneumatic tire service truck, motor grader, trench roller, or other suitable pneumatic tire equipment as approved by the Engineer. Use compaction equipment weighing at least 6 tons.

**Item 511 Structural Concrete, QC 2:** For one driveway as shown in the plans. Said driveway to be installed per the Logan County Technical Design Standards Drawing B-15.

**Item 611:** All conduit is to be composed of ductile iron that meets and/or exceeds the performance and strength requirements of the respective type of conduit as specified in the plans (i.e. Type A, Type C, Type D)

**SPEC: Relocate and cap existing private sewer:** The Contractor shall relocate and cap one existing private sewer as shown on the Plans. It's the understanding of the Engineer that there is only one private sewer along the length of the project.

**SPEC: Hauling and disposing of excavation material and debris:** Prior to hauling and disposing material per the plans, provide written notification to the Engineer detailing hauling routes and where the material will be hauled.

**SPEC: Miscellaneous Catch Basin & Tile Connections:** Includes (1) all miscellaneous work required for the catch basin connections at station 0+15.19 (Of note: the proposed 8" diameter tile shown at station 0+15.19 in the plans may be installed at an elevation of 998.67') and (2) all miscellaneous work required to connect existing tiles into proposed drainage tiles and ditches. All existing drainage structures that the Engineer is aware of are shown on the plans.

**Full Width Paving:** The Contractor shall pave full width unless otherwise authorized by the Engineer.

**RECIPIENTS OF NOTICE FOR BIDS**

Reichert Excavating Inc  
11418 OH 274  
Lewistown, OH 43333  
937-843-6527  
reichertx@live.com

Levan's Excavating, Inc  
4198 State Route 68 South  
West Liberty, OH 43357  
937-599-2535  
elevan@levansexcavating.com

ACS Excavating, LLC  
714 N Napoleon Rd  
Lima, OH 45801  
chad@snyderbrothers.net

Dayton Builders Exchange  
7250 Poe Avenue, Suite 410  
Dayton, OH 45414  
937-278-5723  
info@bxdayton.org

H & S Asphalt, LLC  
2422 US Route 68 North  
Bellefontaine, OH 43311  
937-593-5173  
hsasphaltpaving@hotmail.com

The Shelly Company  
1700 Fostoria Avenue  
Suite 200, PO Box 3100  
Findlay, OH 45840  
bgood@shellyco.com

Dodge Construction Network  
7265 Kenwood Rd  
Cincinnati, OH 45236  
877-784-9556  
support@construction.com

Dayton Builders Exchange  
2077 Embury Park Road



Dayton, OH 45414  
866-907-6300  
info@bxohio.com

Ohio Laborers-Employers Cooperation and Education Trust  
152 Dorchester Square  
Westerville, OH 43081  
614-523-3800  
ohlecet@gmail.com

I Sq. Ft. Construction  
3825 Edwards Road, Ste. 800  
Cincinnati, OH 45209  
877-422-8665  
Ohio@isqft.com

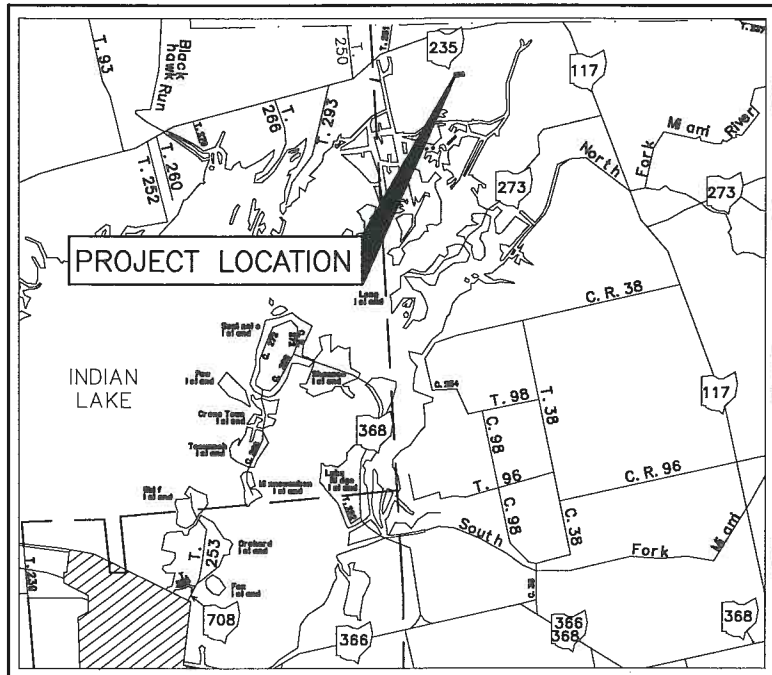

LOCATION MAP

PORTION TO BE IMPROVED -----  
 STATE AND FEDERAL ROUTES -----  
 OTHER ROADS -----

DESIGN DESIGNATION

CURRENT A.D.T. (2022) ----- 77  
 DESIGN YEAR A.D.T. (2042) ----- 94  
 DIRECTIONAL DISTRIBUTION ----- 50%  
 TRUCKS (24 HOUR B&C) ----- 9  
 DESIGN SPEED ----- 35 MPH  
 LEGAL SPEED ----- 35 MPH  
 DESIGN FUNCTIONAL CLASSIFICATION ----- LOCAL

KEY

⊙ ROADWAY -----  
 ⊙ PROPOSED DITCH -----  
 EXISTING FEATURE -----  
 PROPOSED EDGE OF PAVEMENT -----  
 RIGHT-OF-WAY ----- R/W -----  
 PROPERTY LINE ----- PL -----

REMOVE EXISTING FEATURE = ✕

EXISTING TREE OR SHRUB = ☼

EX. = EXISTING  
 PR. = PROPOSED

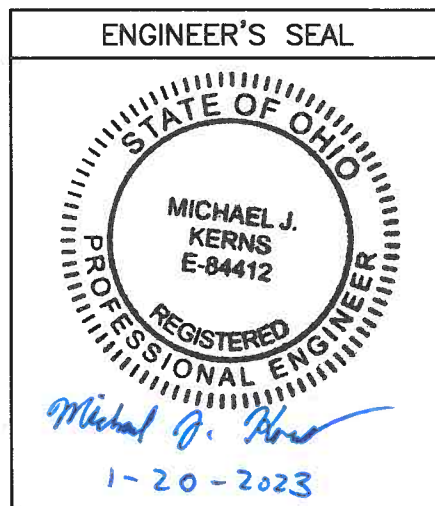

LOGAN COUNTY  
 ENGINEER'S OFFICE  
 SCOTT C. COLEMAN, P.E., P.S.  
 COUNTY ENGINEER  
 CHERRY LANE  
 ROAD IMPROVEMENT

RICHLAND TOWNSHIP  
 2023

INDEX OF SHEETS

TITLE SHEET ----- 1  
 SITE PLAN & PROFILE ----- 2  
 REFERENCE TABLE & GENERAL NOTES ----- 3  
 PAVEMENT NOTES ----- 4  
 TYPICAL SECTION ----- 5  
 CROSS-SECTIONS ----- 6-10

STANDARD CONSTRUCTION DRAWINGS	SUPPLEMENTAL SPECIFICATIONS
	O.D.O.T. CONSTRUCTION AND MATERIALS SPECIFICATIONS, DATED JANUARY 1, 2019
	THE LOGAN COUNTY TECHNICAL DESIGN STANDARDS

PROJECT DESCRIPTION

IMPROVE ALL OF CHERRY LANE BY GRADING, DRAINING, STRAIGHTENING, WIDENING AND PAVING SAID STREET WHICH IS LOCATED IN INDIAN LAKE SHORES ALLOTMENT NO. 1, V.M.S 13393, RICHLAND TOWNSHIP, LOGAN COUNTY, OHIO. SAID STREET BEING ALL OF CHERRY LANE AS SHOWN ON THE PLAT OF INDIAN LAKE SHORES ALLOTMENT NO. 1 (PLAT CABINET A, SLIDE 399).

LOGAN COUNTY ENGINEER APPROVAL

I HEREBY APPROVE OF THESE PLANS AND DECLARE THAT THE MAKING OF THIS IMPROVEMENT WILL REQUIRE THE CLOSING OF THE ROAD TO THROUGH TRAFFIC, AND THAT PROVISIONS FOR THE MAINTENANCE AND SAFETY OF TRAFFIC WILL BE AS SET FORTH ON THESE PLANS.

1-20-23  
 DATE

*Scott C. Coleman*  
 LOGAN COUNTY, OHIO, ENGINEER

FEDERAL PROJECT NO.  
 NON-FEDERAL

PID NO.  
 NONE

WORK ORDER NO.  
 11664

RAILROAD INVOLVEMENT  
 NONE

CHERRY LANE

1/10



PLANS PREPARED BY:  
 LOGAN COUNTY ENGINEER'S OFFICE  
 1991 C.R. 13, P.O. BOX 427  
 BELLEFONTAINE, OHIO 43311

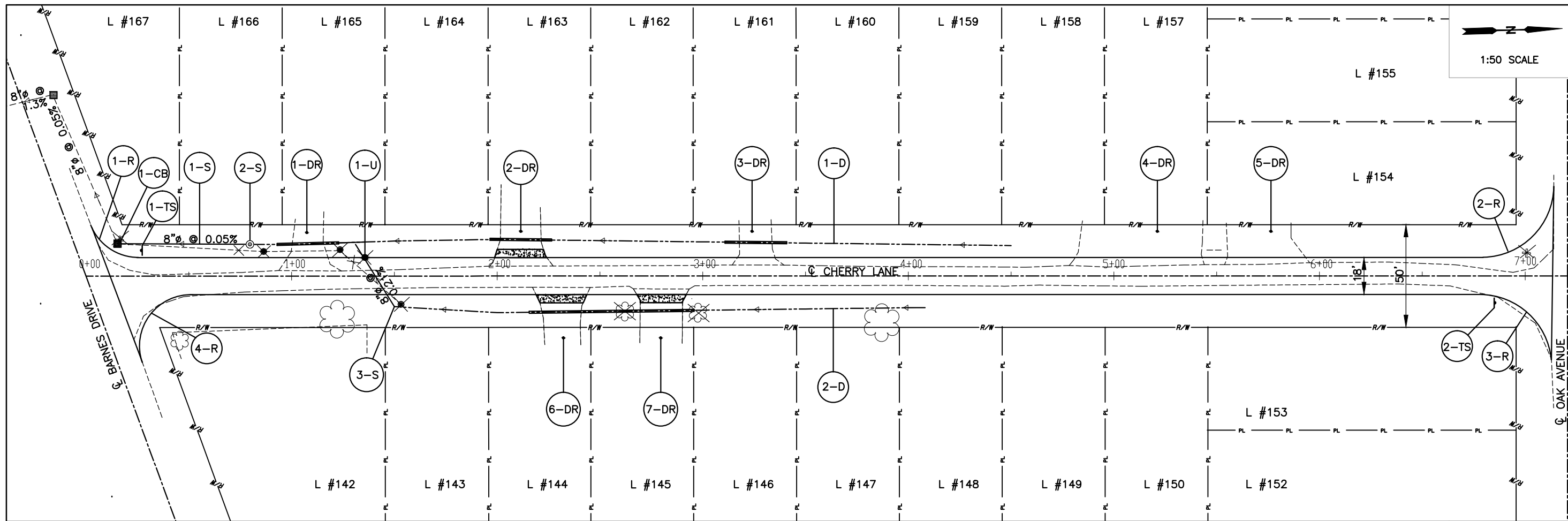

SITE PLAN

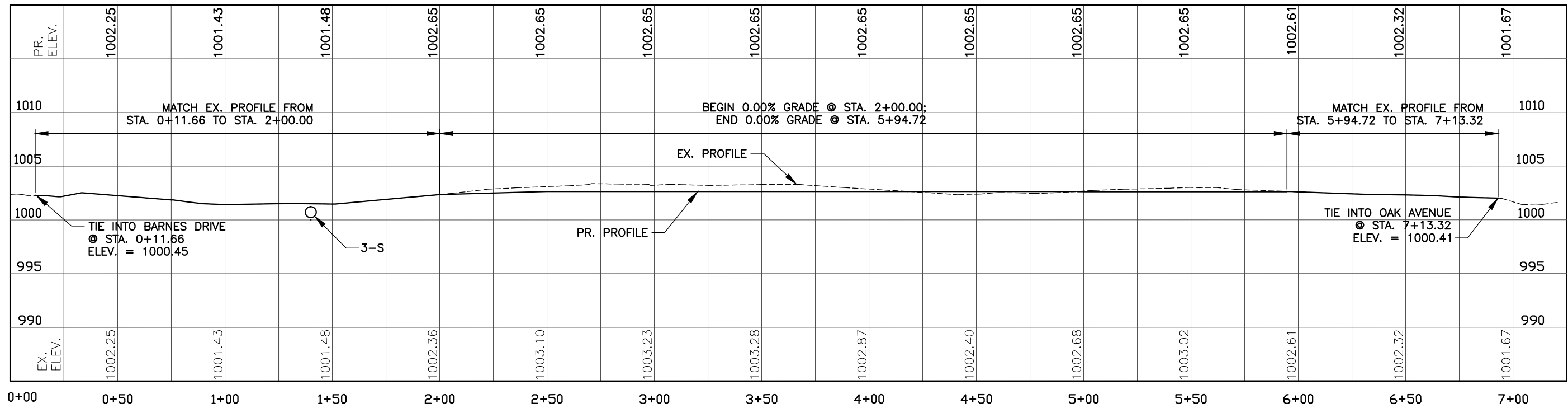

PROFILE

LOGAN COUNTY ENGINEER'S OFFICE  
1991 C.R. 13, P.O. BOX 427  
BELLEFONTAINE, OHIO 43311

DATE: 12/21/2022  
DESIGNED: MJK  
DRAWN: MJK  
REVIEWED: MJK  
WORK ORDER NUMBER: 11664  
CHECKED: SCC

SITE PLAN & PROFILE

CHERRY LANE

2/10

REFERENCE TABLE

REF. NO.	SHEET NO.	DESCRIPTION	STATION (BEGIN, END)	BID ITEM	QUANTITY	UNIT
1-DR	2,6	EX. GRAVEL DRIVE	0+93.00, 1+23.00	611: 8" TYPE D	30	LF
2-DR	2,7	EX. ASPHALT DRIVE	1+96.50, 2+26.50	611: 8" TYPE D	30	LF
3-DR	2,8	EX. GRAVEL DRIVE	3+10.80, 3+40.80	611: 8" TYPE D	30	LF
4-DR	2	EX. GRAVEL DRIVE				
5-DR	2	EX. GRAVEL DRIVE				
6-DR	2,7	EX. ASPHALT DRIVE	2+15.58, 2+45.58	611: 8" TYPE D	30	LF
7-DR	2,7	EX. CONCRETE DRIVE	2+45.58, 2+95.58	611: 8" TYPE D	50	LF
1-R	2,6	PR. RADIUS = 25'	0+11.66, 0+24.75			
2-R	2,10	PR. RADIUS = 35'	6+79.57, 7+13.32			
3-R	2,10	PR. RADIUS = 35'	6+78.18, 7+13.32			
4-R	2,6	PR. RADIUS = 25'	0+11.66, 0+50.70			
1-TS	2	PR. R1-1 ('STOP') TRAFFIC SIGN INSTALLED PER OMUTCD			1	EA
2-TS	2	PR. R1-1 ('STOP') TRAFFIC SIGN INSTALLED PER OMUTCD			1	EA
1-U	2,6	EX. PRIVATE SEWAGE PIPE. RELOCATE EX. PIPE TO EDGE OF RIGHT-OF-WAY AND CAP TO IN-KIND CONDITION.				
1-S	2,6	PR. 8"Ø CULVERT WITH 0.05% GRADE INLET $\bar{\ell}$ : 998.70 OUTLET $\bar{\ell}$ : 998.67	0+15.19, 0+80	611: TYPE C	65	LF
2-S	2,6	PR. 8"Ø METAL GRATE AND TILE CONNECTION TO 8"Ø TILE. TOP OF GRATE FLUSH WITH GROUND ELEV.		611: METAL GRATE INLET	1	EA
3-S	2,6-7	PR. 8"Ø CULVERT WITH 32' RF SKEW & 0.21% GRADE INLET $\bar{\ell}$ : 1000.20 OUTLET $\bar{\ell}$ : 1000.12	1+50 (R), 1+30 (L)	611: TYPE A	36	LF
1-CB	2,6	EX. 2-2 CATCH BASIN TO REMAIN				
1-D	2,5-10	PR. DITCH WITH 0.04% GRADE & MAX 3:1 SLOPES	0+80, 4+50		370	LF
2-D	2,5-10	PR. DITCH WITH 0.04% GRADE & MAX 3:1 SLOPES	1+50, 4+08		258	LF

GENERAL NOTES

1. USE EXCAVATED MATERIAL FROM PROJECT SITE WHEN SAID MATERIAL CONFORMS TO PROJECT SPECIFICATIONS
2. HAUL AND DISPOSE OF ALL THE EXCAVATED MATERIAL AND DEBRIS FROM SITE THAT DOES NOT CONFORM TO GENERAL NOTE (1)
3. DRIVEWAYS ARE TO BE REPAIRED IN-KIND AND ALL DRIVEWAYS MUST ADHERE TO DRAWING B-15 OF THE LOGAN COUNTY TECHNICAL DESIGN STANDARDS
4. ITEM #304: QUANTITIES SHOWN ON BID SHEET INCLUDE THE AGGREGATE FOR GRAVEL DRIVEWAYS
5. ITEM #404: QUANTITIES SHOWN ON BID SHEET INCLUDES THE ASPHALT FOR DRIVEWAYS 2-DR AND 6-DR
6. ITEM #511: QUANTITIES SHOWN ON BID SHEET INCLUDES THE CONCRETE FOR DRIVEWAY 7-DR
7. EX. DRAINAGE TILES ARE BE HANDLED IN ACCORDANCE WITH ODOT CMS ITEM 202
8. TEMPORARY SEDIMENT AND EROSION CONTROL: INSTALL DROP INLET PROTECTION IN THE FORM OF A SILT SACK OR EQUIVALENT FILTER DEVICE ON 1-CB
9. ITEM #611, TYPE A, C, AND D: PIPE MATERIAL TO BE DUCTILE IRON
10. NOTIFICATION OF TRAFFIC RESTRICTIONS: THE CONTRACTOR SHALL NOTIFY THE COUNTY ENGINEER 21 DAYS BEFORE BEGINNING CONSTRUCTION AND SHALL PERSONALLY NOTIFY THE LANDOWNERS ABUTTING CHERRY LANE 14 DAYS BEFORE BEGINNING CONSTRUCTION. THE COUNTY ENGINEER'S OFFICE WILL NOTIFY THE PUBLIC ABOUT THE ROAD CLOSURE 14 DAYS PRIOR TO CLOSURE. LOCAL TRAFFIC WILL BE MAINTAINED WHEN POSSIBLE. THE LOGAN COUNTY ENGINEER'S OFFICE WILL PROVIDE PROPER 'ROAD CLOSED' SIGNAGE.

DESIGN AGENCY  
 LOGAN COUNTY ENGINEER'S OFFICE  
 1991 C.R. 13, P.O. BOX 427  
 BELLEFONTAINE, OHIO 43311

DATE  
 12/21/2022  
 REVIEWED  
 WTB  
 WORK ORDER NUMBER  
 11664

DRAWN  
 MJK  
 DESIGNED  
 MJK  
 CHECKED  
 SCC

REFERENCE TABLE & GENERAL NOTES

CHERRY LANE

AGGREGATE

THE CONTRACTOR SHALL PROVIDE THE NAME AND LOCATION OF THE AGGREGATE PRODUCER PROVIDING THE AGGREGATE FOR THIS PROJECT. THE ENGINEER SHALL THEN INFORM THE LABORATORY, WHO WILL TEST THE AGGREGATE TO INSURE IT COMPLIES WITH ALL OF THE REQUIREMENTS OF THE O.D.O.T. SPECIFICATIONS. HOWEVER, IF THE AGGREGATE HAS BEEN PREVIOUSLY TESTED BY THE COUNTY, NO TESTING WILL BE REQUIRED. THE PERCENTAGE OF CRUSHED AGGREGATE SHALL BE DETERMINED BY COUNTING THE NUMBER OF SINGLE FRACTURED FACES. THE COUNTY MAY PERFORM DURABILITY TESTING OF THE AGGREGATE STOCKPILE.

JOB MIX FORMULA

THE JOB MIX FORMULA SHALL BE DESIGNED FOR LOW VOLUME TRAFFIC. WARM MIX ASPHALT IS REQUIRED FOR THIS PROJECT. THE CONTRACTOR SHALL PROVIDE THE JOB MIX FORMULA TO THE ENGINEER AT THE TIME OF BIDDING. THE ENGINEER SHALL FORWARD THE JMF TO THE LABORATORY FOR VERIFICATION.

JOB MIX

JOB MIX FORMULA SHALL BE 20% PERCENT R.A.P. (RECLAIMED ASPHALT PAVEMENT) MAXIMUM FOR SURFACE MATERIAL. JOB MIX FORMULA MUST INCLUDE MAXIMUM PERCENT OF R.A.P. PROPOSED AND MINIMUM PERCENT VIRGIN ASPHALT BINDER PROPOSED FOR ALL MIXES BEING BID.

ASPHALT BINDER

SHALL BE BINDER GRADE PG58-28.

ITEM 402LVT (AS PER PLAN)

IS A COARSE VERSION OF THE OHIO DOT 404LVT. THIS AS PER PLAN MIX DESIGN WILL BE USED FOR LEVELING AND INTERMEDIATE MAT PLACEMENT. ODOT SPECIFICATION ITEM 404LVT SHALL BE FOLLOWED WHEN DEVELOPING JMF WITH EXCEPTION OF MIXTURE PROPORTIONS OUTLINED BELOW. COMPLETE MIX DESIGN DOCUMENTATION SHALL BE PROVIDED ALONG WITH THE JMF AT THE TIME OF BIDDING FOR APPROVAL BY THE COUNTY ENGINEER.

402LVT (AS PER PLAN) - MIXTURE PROPORTIONS  
50-BLOW MARSHALL

SIEVE	TOTAL PERCENT PASSING
1 1/2	100
1	95 TO 100
3/4	90 TO 100
1/2	75 TO 90
#4	50 TO 65
#8	35 TO 50
#16	25 TO 40
#30	15 TO 30
#50	8 TO 16
#100	2 TO 10
TOTAL BINDER	5.5 TO 6.5 INDICATE GRAVEL OR LESTONE COARSE AGGREGATE
VIRGIN BINDER	5.3 (MINIMUM)
BINDER GRADE	PG 58-28
AIR VOIDS	3.5%

ITEM 404LVT, EXTRA MATERIAL

QUANTITIES OF ASPHALT CONCRETE HAVE BEEN PROVIDED TO CORRECT SURFACE IRREGULARITIES AND TO PROVIDE FOR TWO FEET WIDE TAPERS AT DRIVEWAYS AND MAILBOXES. ADDITIONAL QUANTITIES HAVE ALSO BEEN PROVIDED TO RESURFACE INTERSECTIONS TO THE RIGHT OF WAY LINE. THESE QUANTITIES ARE ESTIMATED AND SHALL BE USED AT THE DIRECTION OF THE ENGINEER OR THE ENGINEER'S DESIGNEE. ALL EXTRA MATERIAL SHALL BE OF THE SAME TYPE AS USED FOR THE FINISH COURSE.

ASPHALT BINDER PRICE ADJUSTMENT

2019 O.D.O.T. CMS, SHALL NOT APPLY TO THIS PROJECT

TESTING

THE ENGINEER'S REPRESENTATIVE MAY COLLECT A SAMPLE OF THE MATERIAL BEING DELIVERED TO THE PROJECT. EACH SAMPLE SHALL BE MARKED WITH THE DATE, TIME THE SAMPLE WAS TAKEN, AND THE DELIVERY TICKET NUMBER. THE SAMPLES WILL BE ANALYZED BY THE LABORATORY FOR ASPHALT CONTENT, GRADATION AND AGGREGATE PROPERTIES.

QUALITY CONTROL

NOTIFY THE ENGINEER A MINIMUM OF 48 HOURS, EXCLUDING WEEKENDS AND LEGAL HOLIDAYS, PRIOR TO STARTING ASPHALT CONCRETE PRODUCTION. THE FAILURE TO PROVIDE THE REQUIRED MINIMUM NOTICE MAY RESULT IN THE ENGINEER BEING UNABLE TO OBSERVE THE TESTING AS MAY BE REQUIRED BY THIS SPECIFICATION. PRODUCTION AND/OR PLACEMENT OF ASPHALT SHALL NOT TAKE PLACE WITHOUT TESTING EQUIPMENT BEING IN PROPER WORKING ORDER.

THE MINIMUM ASPHALT BINDER CONTENT AS SPECIFIED HEREIN BY THE APPROVED JMF FOR EACH TYPE OF ASPHALT MATERIAL PER DAY OF PRODUCTION AND PLACEMENT SHALL BE TESTED IN ACCORDANCE WITH AASHTO T-287 AND ASTM D 4125. ASPHALT CONTENT OF EACH ASPHALT MATERIAL TYPE SHALL BE TESTED A MINIMUM OF ONE (1) TIME PER 500 TONS OF PRODUCTION DURING EACH DAY. THE ENGINEER OR HIS DESIGNATED REPRESENTATIVE SHALL DETERMINE WHEN, DURING THE DAY'S PRODUCTION, EACH OF THE REQUIRED TESTS SHALL BE MADE; HOWEVER, THE CONTRACTOR MAY CONDUCT ADDITIONAL TESTS BEYOND THOSE ORDERED BY THE ENGINEER TO ENSURE PROPER QUALITY CONTROL.

DOCUMENT EACH ASPHALT CONTENT TEST IN A MANNER ACCEPTABLE TO THE ENGINEER'S REPRESENTATIVE. AT A MINIMUM INCLUDE IN EACH TEST REPORT THE INFORMATION SPECIFIED IN AASHTO T-287. PROVIDE THE WRITTEN TEST REPORTS TO THE ENGINEER AS SOON AS PRACTICABLE UPON COMPLETION OF EACH TEST.

WHEN DIRECTED BY THE ENGINEER, PROVIDE SAMPLES OF MATERIAL PER 403.06. SAMPLES OBTAINED PER 403.06 WILL BE USED, AT THE ENGINEER'S DISCRETION, TO DETERMINE AGGREGATE GRADATION.

THE ENGINEER MAY ORDER ADDITIONAL TESTS BASED ON THE SCOPE OF THE PROJECT, SCHEDULE OF ASPHALT CONCRETE PLACEMENT, OR IF WORKMANSHIP PROBLEMS BECOME EVIDENT. NOTHING IN THIS SPECIFICATION, IF AND WHEN DEEMED NECESSARY, SHALL PRECLUDE THE ENGINEER FROM OBTAINING AND TESTING SAMPLES BY ANY OTHER GENERALLY ACCEPTABLE METHOD, IN ACCORDANCE WITH ESTABLISHED STANDARDS AND PRACTICES.

PAYMENT AND ACCEPTANCE

PAYMENT FOR ASPHALT CONCRETE PAVING ITEMS REPRESENTING EACH DAY'S PRODUCTION WILL BE AS ACCEPTED AND AUTHORIZED BY THE ENGINEER ON THE BASIS OF WEIGHT SLIPS AND THE FOLLOWING PAY SCHEDULE. WEIGHT SLIPS SHALL INDICATE GROSS, TARE, AND NET WEIGHTS, NOT BATCH WEIGHTS.

ACCEPTANCE AND PAYMENT FOR EACH TYPE OF MATERIAL WILL BE BASED ON THE MEASURED TOTAL ASPHALT BINDER CONTENT AS COMPARED WITH THAT SPECIFIED, AND VERIFIED THROUGH LABORATORY TEST RESULTS AND THE DATA LOGS. ALL PRODUCTION DATA LOGS SHALL BE CORRELATED TO THE LOADING TIME BY THE PRODUCTION PLANT. QUALITY CONTROL REPORTS SHALL BE SUBMITTED USING OHIO DOT CONTRACTOR FORM TE-199. RESULTING PAY ADJUSTMENT(S) WILL BE MADE IN ACCORDANCE WITH THE FOLLOWING PAY SCHEDULE:

PAY FACTOR	DEVIATION BELOW REQUIRED TOTAL ASPHALT BINDER CONTENT	MINIMUM SPECIFIED
1.00	0.00 TO 0.10	
0.99	0.11 TO 0.20	
0.98	0.21 TO 0.30	
0.95	0.31 TO 0.40	
0.70	0.41 TO 0.50	
REMOVAL	MORE THAN 0.50	

THE PAY FACTOR WILL BE APPLIED TO THE UNIT PRICE FOR THE RESPECTIVE ITEM IN THE CONTRACT WHEN CALCULATING PAYMENT PROGRESS ESTIMATES.

DESIGN AGENCY  
LOGAN COUNTY ENGINEER'S OFFICE  
1991 C.R. 13, P.O. BOX 427  
BELLEFONTAINE, OHIO 43311

DATE  
12/21/2022  
REVIEWED  
WTB  
WORK ORDER NUMBER  
11664

DRAWN  
MJK  
REVISION  
DESIGNED  
MJK  
CHECKED  
SOC

PAVEMENT NOTES

CHERRY LANE

4  
10

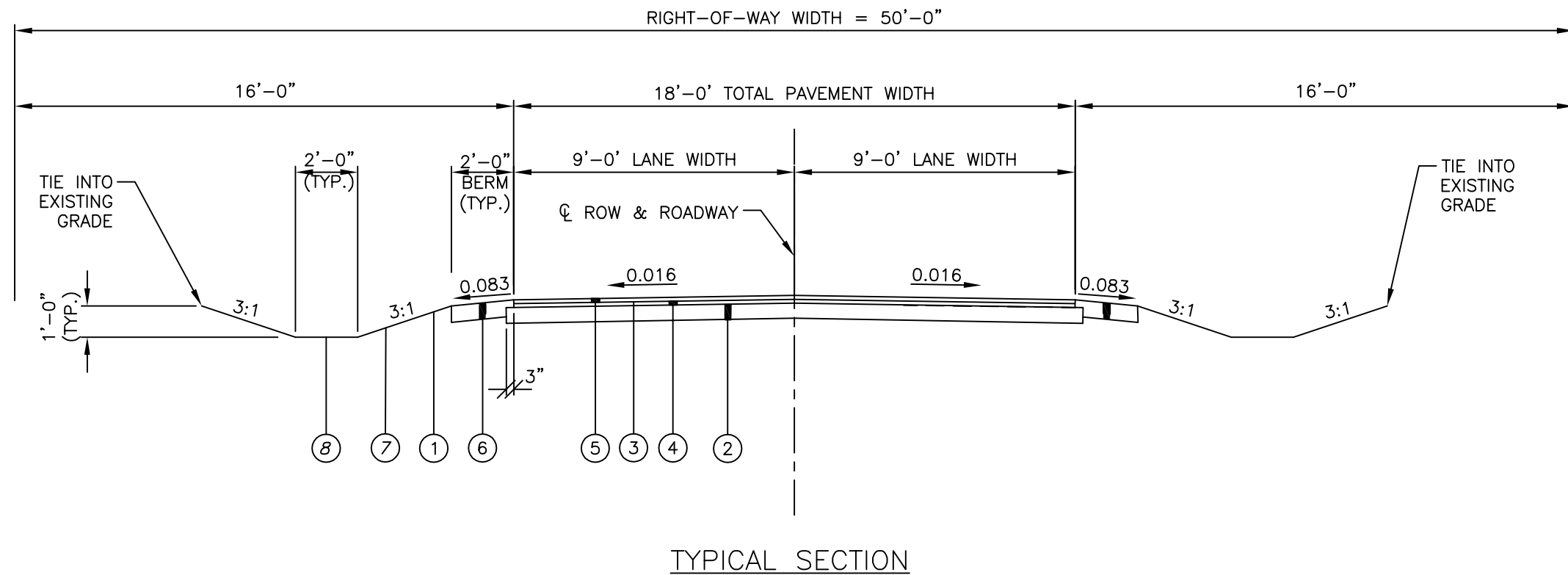

**LEGEND**

- ① ITEM 203 EXCAVATION & EMBANKMENT, AS PER CROSS SECTIONS
- ② ITEM 304 9" AGGREGATE BASE
- ③ ITEM 407 TACK COAT, 0.075 GAL./SQ. YD.
- ④ 402 LVT 2" INTERMEDIATE COURSE, PG58-28
- ⑤ 404 LVT 1½" SURFACE COURSE, PG58-28
- ⑥ ITEM 411 CRUSHED BERM, TYPE A, 6" MIN. REV. 4-17-23
- ⑦ ITEM 659 TOPSOIL FURNISHED AND PLACED (4" DEPTH) REV. 4-17-23
- ⑧ ITEM 659 SEEDING AND MULCHING, CLASS 1

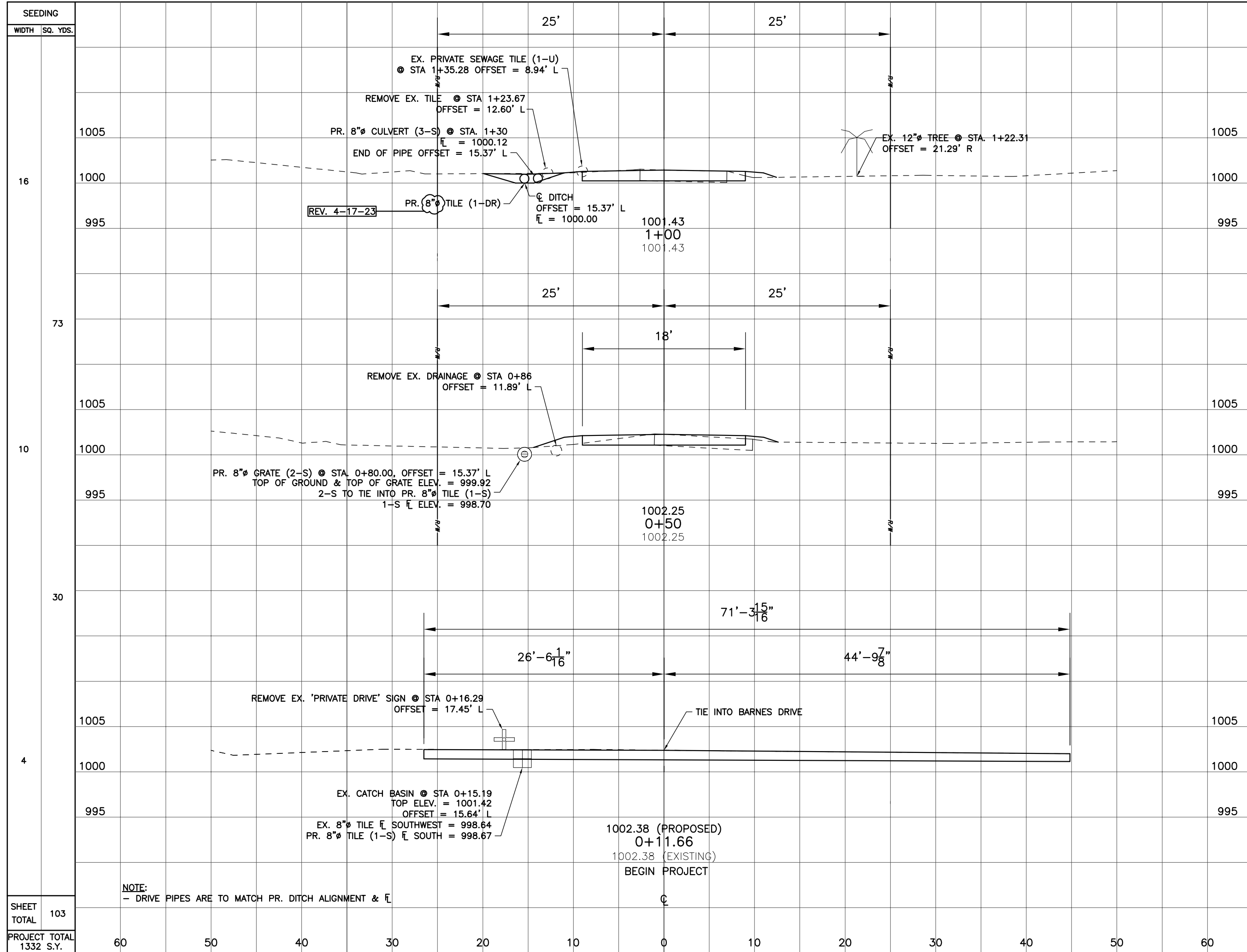

SEEDING		END AREA		VOLUME	
WIDTH	SQ. YDS.	CUT	FILL	CUT	FILL
16		17.4	1.9		
73				22.1	5.0
10		6.5	3.5		
30				6.8	4.6
4		3	3		
SHEET TOTAL		28.9	9.6		
PROJECT TOTAL 1332 S.Y.		394	104		

DESIGNED: MJK  
 CHECKED: SCC  
 CROSS SECTIONS  
 STA. 0+11.66 TO 1+00  
 CHERRY LANE  
6  
10

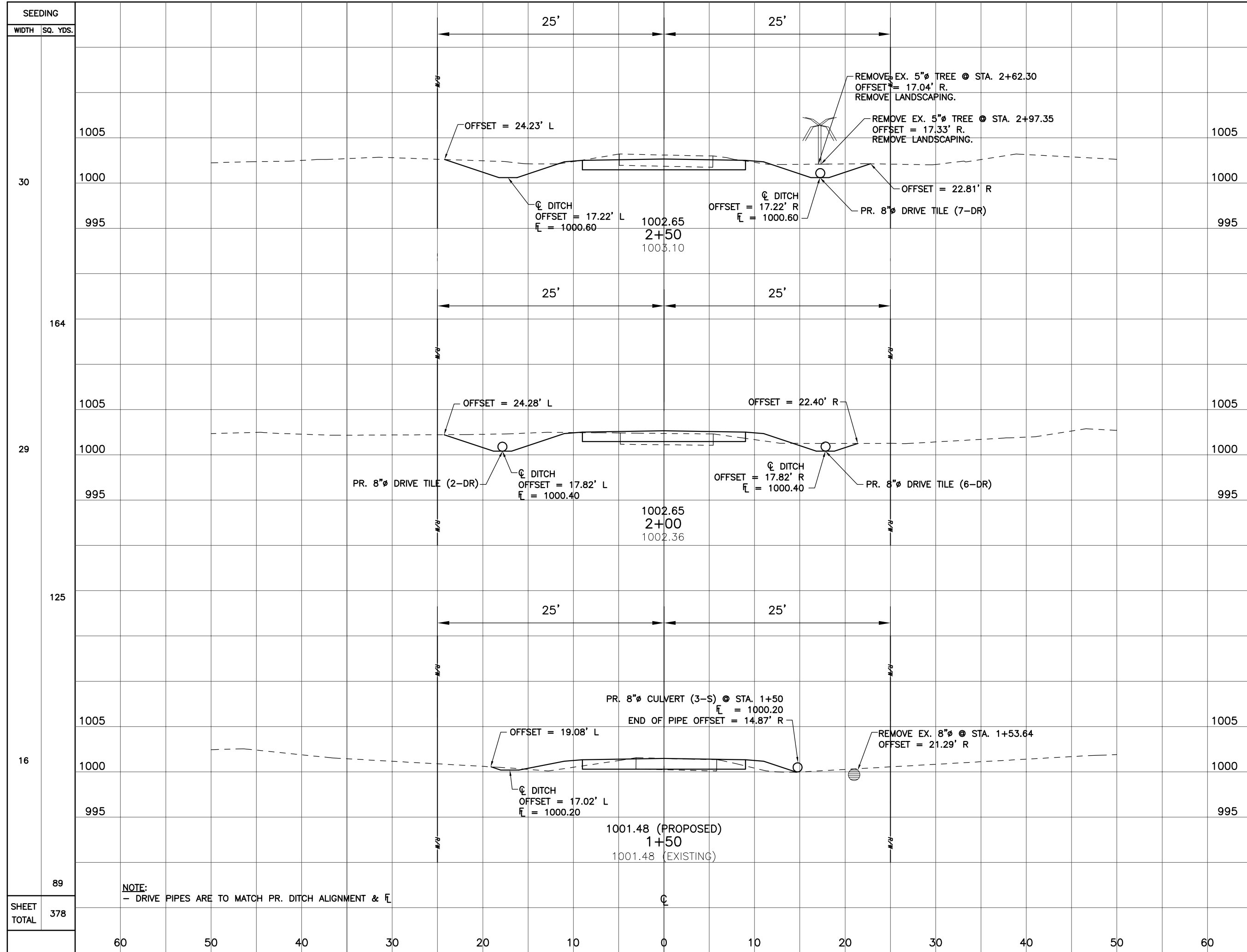

CROSS SECTIONS  
STA. 1+50 TO 2+50

CHERRY LANE



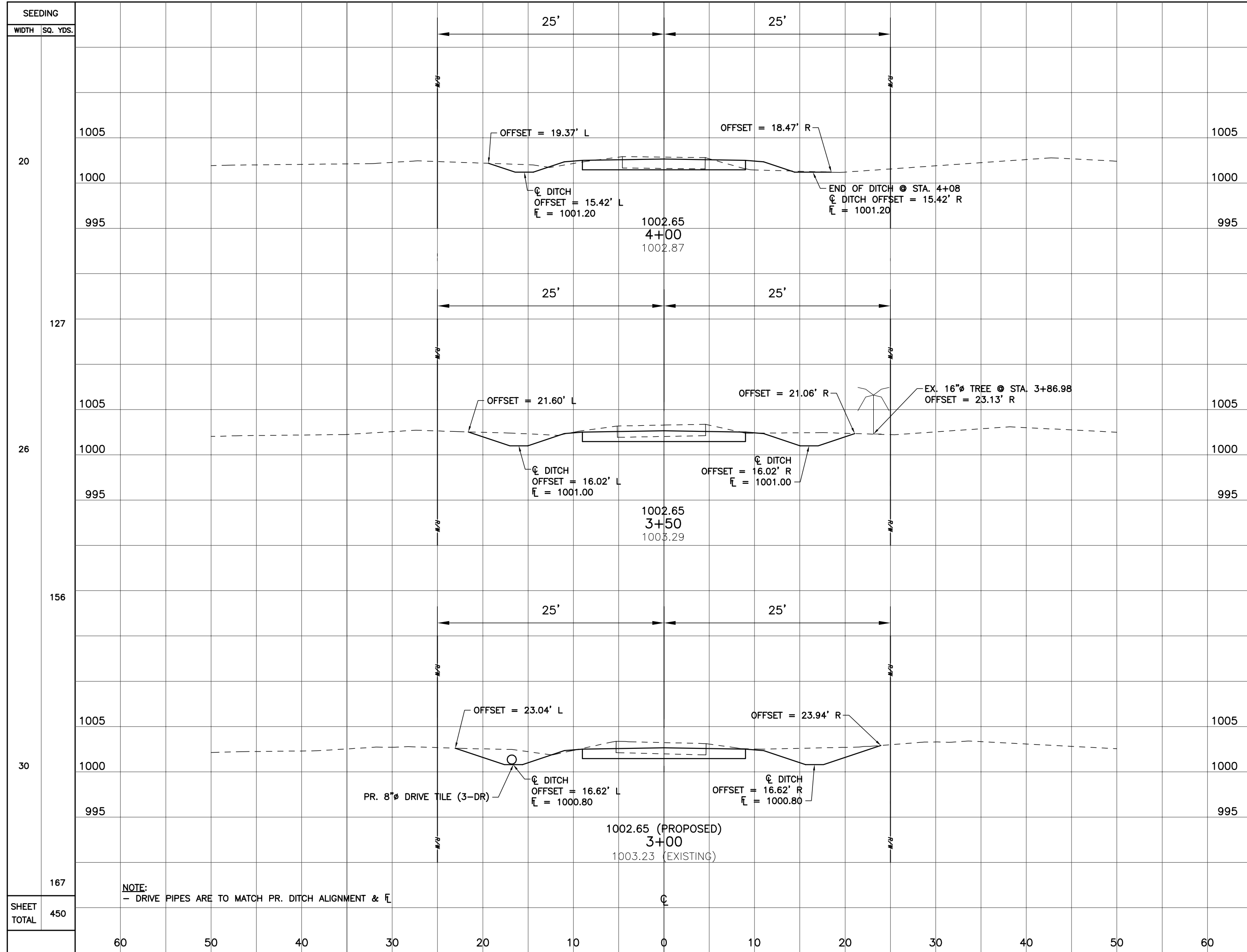

SEEDING		END AREA		VOLUME	
WIDTH	SQ. YDS.	CUT	FILL	CUT	FILL
20		11.9	3.8		
127				38.0	3.5
26		29.1	0.0		
156				70.7	0.0
30		47.2	0.0		
167				73.5	0.0
<b>SHEET TOTAL</b>	<b>450</b>	<b>182.2</b>	<b>3.5</b>		

DESIGNED MJK  
 CHECKED SCC  
 CROSS SECTIONS  
 STA. 3+00 TO 4+00  
 CHERRY LANE  
 8  
 10

NOTE:  
 - DRIVE PIPES ARE TO MATCH PR. DITCH ALIGNMENT & FL

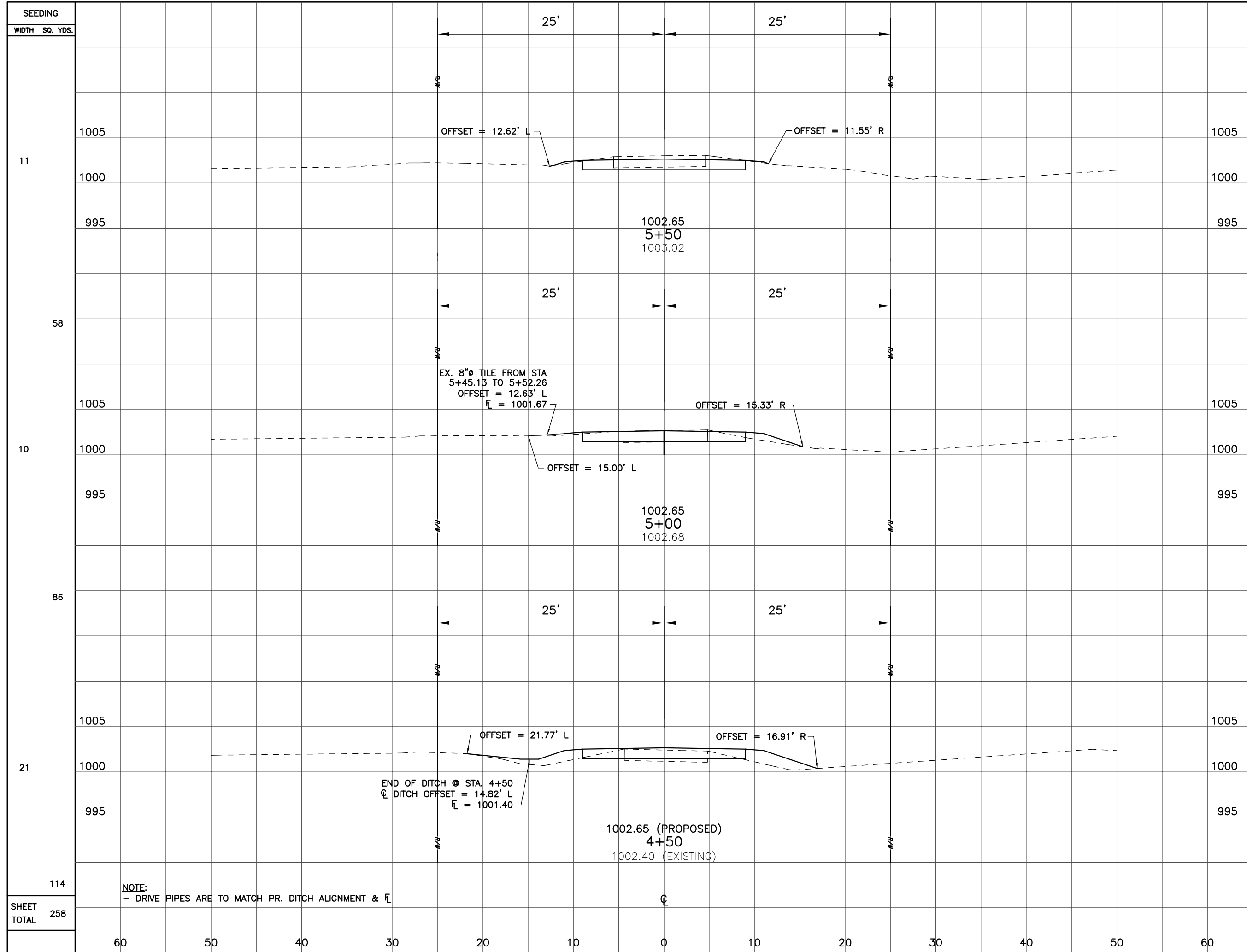

SEEDING		END AREA		VOLUME	
WIDTH	SQ. YDS.	CUT	FILL	CUT	FILL
11		10.4	0.0		
58				17.0	3.2
10		8.0	3.5		
86				11.3	15.6
21		4.2	13.3		
114				14.9	15.8
<b>SHEET TOTAL</b>	<b>258</b>	<b>43.2</b>	<b>34.6</b>		

DESIGNED: MJK  
 CHECKED: SCC  
 CROSS SECTIONS  
 STA. 4+50 TO 5+50  
 CHERRY LANE  
 9  
 10

**NOTE:**  
 - DRIVE PIPES ARE TO MATCH PR. DITCH ALIGNMENT &  $\bar{L}$

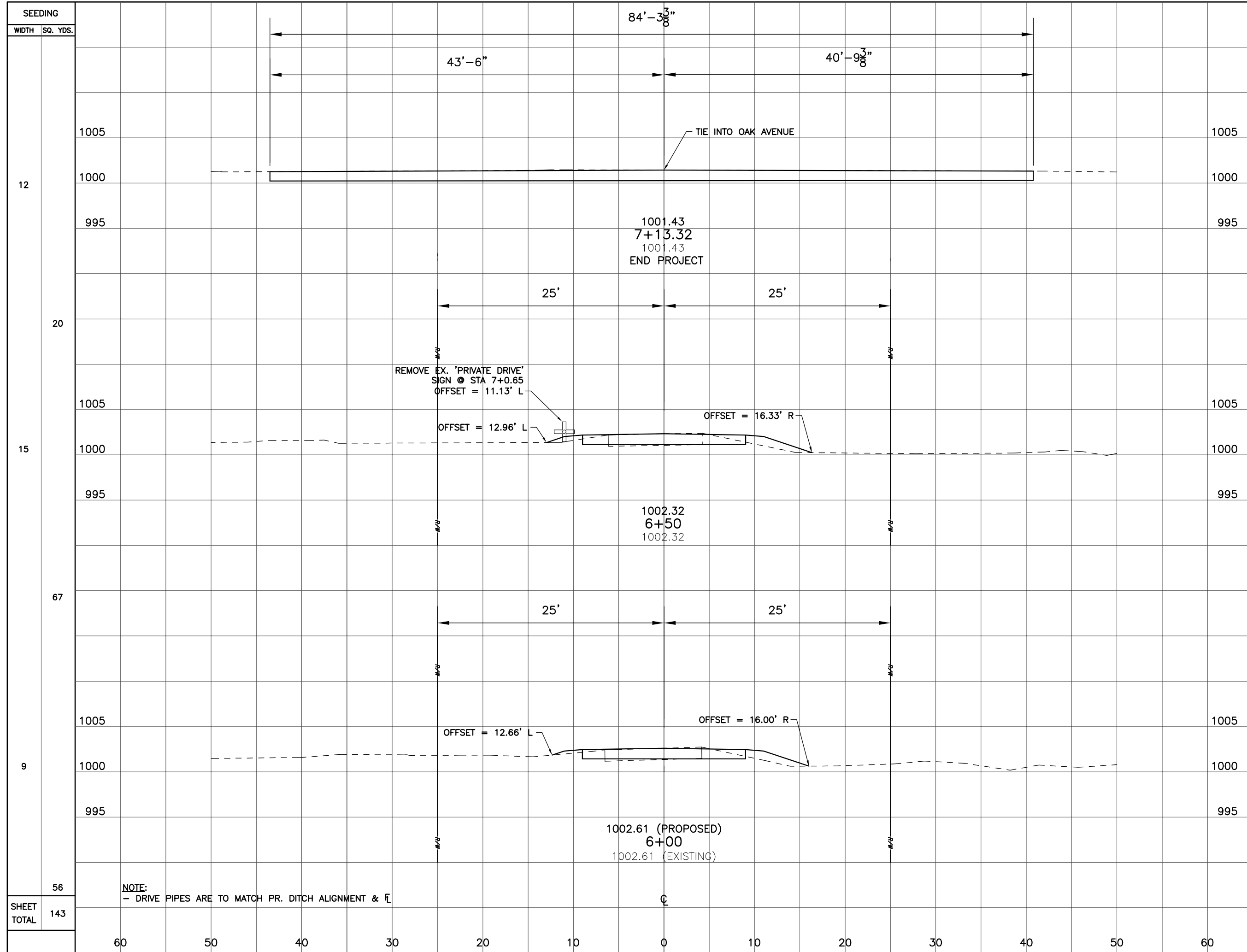

CROSS SECTIONS  
STA. 6+00 TO 7+13.32

CHERRY LANE

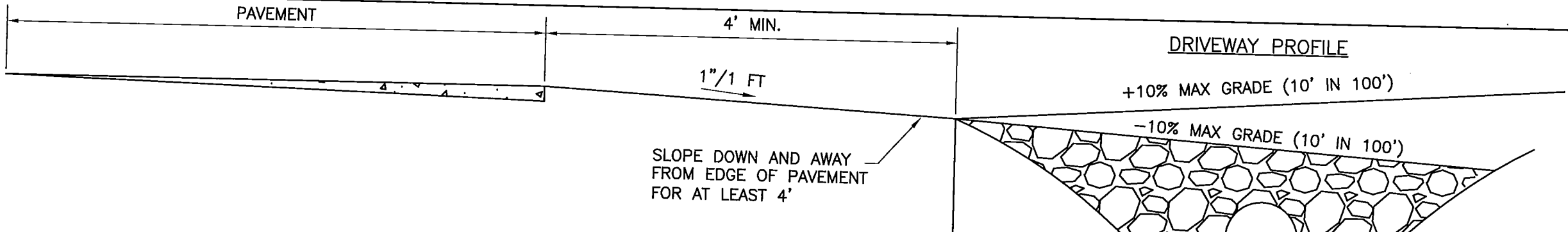

**NOTES**

1. MAXIMUM LONGITUDINAL GRADE ON A DRIVEWAY SHALL BE 10% (10' in 100'). DRIVEWAYS SHALL BE CROWNED.
2. DRIVEWAY PIPE (IF REQUIRED) SHALL BE INSTALLED IN ACCORDANCE WITH THESE SPECIFICATIONS.
3. THE PROPERTY OWNER, BUILDER OR DEVELOPER IS REQUIRED TO CONSTRUCT DRIVEWAYS & DRIVEPIPES & TO KEEP THOSE & APPROACHES IN GOOD REPAIR & WORKING CONDITION. (SEE O.R.C. 5543.16)
4. THE DRIVEWAY & DRIVEPIPE SHALL BE REPLACED IF NOT INSTALLED PROPERLY OR KEPT IN GOOD WORKING CONDITION. IF REPLACEMENT IS NOT COMPLETED WITHIN 15 DAYS AFTER NOTIFICATION BY LOGAN COUNTY, LOGAN COUNTY WILL DO THE WORK & THE COST WILL BE ASSESSED TO THE PROPERTY OWNER.
5. A PERMIT MUST BE OBTAINED FROM THE LOGAN COUNTY ENGINEER. NO CONSTRUCTION SHALL START UNLESS A PERMIT IS OBTAINED.
6. THE COUNTY ENGINEER SHALL DETERMINE THE SIZE (DIAMETER) OF THE CULVERT REQUIRED.
7. NO DRIVEWAY SHALL INTERSECT A PUBLIC ROAD AT ANGLE OF LESS THAN 70°. 90° IS PREFERRED.
8. THE GRADE SHALL BE ON THE FLOW LINE OF THE EXISTING SIDE DITCH & SHALL SLOPE WITH THE NATURAL GRADE OF THE DITCH UNLESS OTHERWISE DIRECTED BY THE ENGINEER.
9. THE OWNER SHALL BE RESPONSIBLE FOR THE PURCHASE OF ALL THE MATERIALS & THE INSTALLATION OF THE MATERIALS & SHALL PAY ALL THE COSTS OF SAID MATERIALS & LABOR.
10. THE COUNTY MAY INSPECT THE DRIVEWAY AFTER CONSTRUCTION TO CHECK COMPLIANCE OF THE ABOVE.

DRIVEWAY MATERIALS	
FARM OR UTILITY	6" (MIN.) CRUSHED AGGREGATE
RESIDENTIAL	2" ASPHALT CONCRETE OVER 6"(MIN.) CRUSHED AGGREGATE OR
	8" (MIN.) CRUSHED AGGREGATE OR
	6" CONCRETE (REINFORCING RECOMMENDED)
COMMON ACCESS	SEE APPENDIX B

- ACCEPTABLE PIPE**
1. RIVETED OR WELDED CORRUGATED METAL
  2. REINFORCED CONCRETE PIPE
  3. DOUBLE WALLED CORRUGATED PLASTIC (ADS N12)

ODOT ITEM 304 OR 411 BEDDING AND BACKFILL AROUND DRIVE PIPES. 57'S WOULD BE RECOMMENDED IF DITCH IS WET.

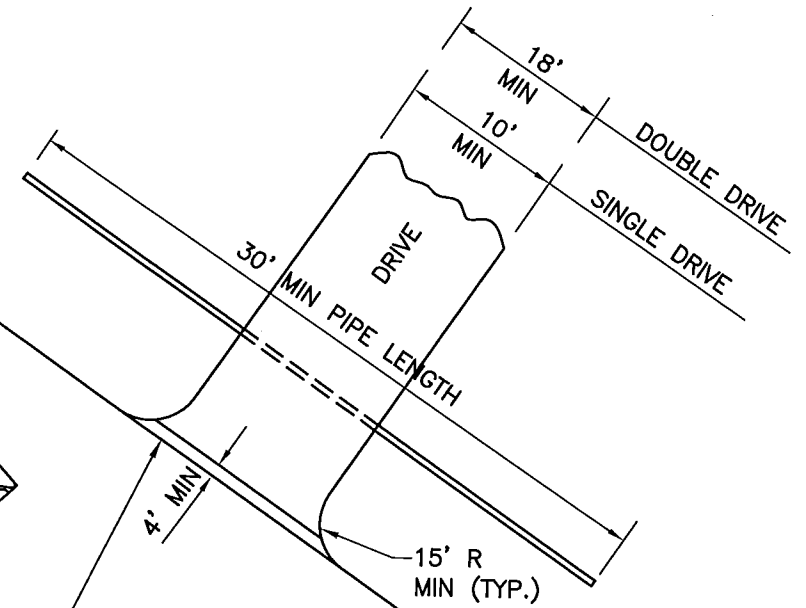
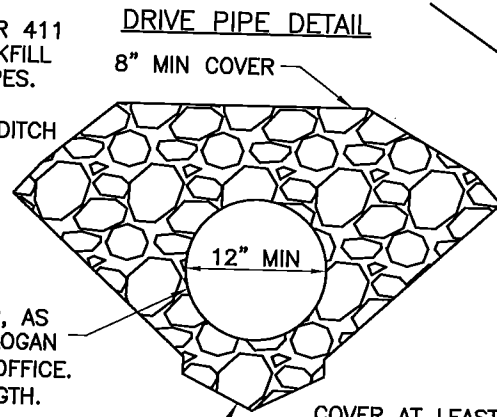

CONCRETE DRIVEWAYS SHALL TERMINATE 4' MIN FROM EDGE OF ROADWAY PAVEMENT (PLACE 2" ASPHALT OVER 6" CRUSHED STONE BETWEEN CONCRETE DRIVEWAY & EDGE OF PAVEMENT).

**BID SHEET  
CHERRY LANE ROAD IMPROVEMENT**

**Engineer's Estimate: \$107,358**

To the Commissioners of Logan County, Ohio:

The undersigned, having full knowledge of the site, plans and specifications for the above named project, and the conditions of the bid, hereby agrees to furnish to the Commissioners of Logan County all services, labor, materials and equipment necessary to complete said project, according to the plans and specifications, and to accept the unit prices specified below as full compensation for the work.

ITEM	QUAN	UNIT	DESCRIPTION	UNIT BID PRICE (\$)	TOTAL (\$)
201	1	LUMP	Clearing and Grubbing		
202	1	LUMP	Removal of structures and obstructions		
203	498	CY	Excavation & Embankment		
204	1501	SY	Subgrade Compaction		
209	628	LF	Linear Grading		
304	360	TON	Aggregate Base (9" depth)		
402	175	TON	402 LVT Asphalt Concrete Base Course, PG 58-28 (2" depth)		
404	130	TON	404 LVT Asphalt Concrete Surface Course, PG 58-28 (1.5" depth)		
407	116	GAL	Tack Coat		
411	111	TON	Crushed Berm Aggregate (agg. size # 617)		
511	1	CY	Structural Concrete, QC 2 (1 driveway)		
611	36	FT	8" ø Type A: Ductile iron		
611	65	FT	8" ø Type C: Ductile iron		
611	170	FT	8" ø Type D: Ductile iron		
611	1	EA	8" Metal Grate Inlet (includes connection to 8" ø tile)		
659	1332	SY	Seeding (Hydroseed Class 1)		
659	0.12	TON	Commercial Fertilizer		
659	7409	GAL	Watering		
SPEC	1	LUMP	Miscellaneous catch basin & tile connections		
SPEC	1	LUMP	Hauling and disposing of excavation material and debris		
SPEC	1	LUMP	Temporary sediment and erosion control (drop inlet protection)		
SPEC	1	LUMP	Relocate and cap private sewage tile		
SPEC	60	LF	Saw cut existing driveways (2 asphalt, 1 concrete)		
<b>CONSTRUCTION TOTAL (\$):</b>					

BID CONSTRUCTION TOTAL (written): \_\_\_\_\_

\_\_\_\_\_  
BIDDER

\_\_\_\_\_  
SIGNATURE

# Prevailing Wage Rate Skilled Crafts

Name of Union: **Labor HevHwy 3**

Change # : LCN01-2023ibLocalHevHwy3

Craft : Laborer Group 1 Effective Date : 05/01/2023 Last Posted : 04/26/2023

	BHR		Fringe Benefit Payments						Irrevocable Fund		Total PWR	Overtime Rate
			H&W	Pension	App Tr.	Vac.	Annuity	Other	LECET (*)	MISC (*)		
Classification												
Laborer Group 1	\$34.62		\$8.20	\$4.05	\$0.45	\$0.00	\$1.00	\$0.00	\$0.10	\$0.00	\$48.42	\$65.73
Group 2	\$34.79		\$8.20	\$4.05	\$0.45	\$0.00	\$1.00	\$0.00	\$0.10	\$0.00	\$48.59	\$65.98
Group 3	\$35.12		\$8.20	\$4.05	\$0.45	\$0.00	\$1.00	\$0.00	\$0.10	\$0.00	\$48.92	\$66.48
Group 4	\$35.57		\$8.20	\$4.05	\$0.45	\$0.00	\$1.00	\$0.00	\$0.10	\$0.00	\$49.37	\$67.15
Watch Person	\$27.35		\$8.20	\$4.05	\$0.45	\$0.00	\$1.00	\$0.00	\$0.10	\$0.00	\$41.15	\$54.83
<b>Apprentice</b>	<b>Percent</b>											
0-1000 hrs	60.00	\$20.77	\$8.20	\$4.05	\$0.45	\$0.00	\$1.00	\$0.00	\$0.10	\$0.00	\$34.57	\$44.96
1001-2000 hrs	70.00	\$24.23	\$8.20	\$4.05	\$0.45	\$0.00	\$1.00	\$0.00	\$0.10	\$0.00	\$38.03	\$50.15
2001-3000 hrs	80.00	\$27.70	\$8.20	\$4.05	\$0.45	\$0.00	\$1.00	\$0.00	\$0.10	\$0.00	\$41.50	\$55.34
3001-4000 hrs	90.00	\$31.16	\$8.20	\$4.05	\$0.45	\$0.00	\$1.00	\$0.00	\$0.10	\$0.00	\$44.96	\$60.54
More than 4000 hrs	100.00	\$34.62	\$8.20	\$4.05	\$0.45	\$0.00	\$1.00	\$0.00	\$0.10	\$0.00	\$48.42	\$65.73

**Special Calculation Note :** Watchmen have no Apprentices. Tunnel Laborer rate with air-pressurized add \$1.00 to the above wage rate.

**Ratio :**

1 Journeymen to 1 Apprentice  
3 Journeymen to 1 Apprentice thereafter

**Jurisdiction ( \* denotes special jurisdictional note ) :**

LOGAN

**Special Jurisdictional Note :**

Hod Carriers and Common Laborers - Heavy, Highway, Sewer, Utility, Waterworks, Airport, Railroad, Industrial and Building Site, Sewer Plant, Waste Water Treatment Facilities Construction

**Details :**

**Group 1**

Laborer (Construction); Plant Laborer or Yardman, Right-of-way Laborer, Landscape Laborer, Highway Lighting Worker, Signalization Worker, (Swimming) Pool Construction Laborer, Utility Man, \*Bridge Man, Handyman, Joint Setter, Flagperson, Carpenter Helper, Waterproofing Laborer, Slurry Seal, Seal Coating, Surface Treatment or Road Mix Laborer, Riprap Laborer & Grouter, Asphalt Laborer, Dump Man (batch trucks), Guardrail & Fence Installer, Mesh Handler & Placer, Concrete Curing Applicator, Scaffold Erector, Sign Installer, Hazardous Waste (level D), Diver Helper, Zone Person and Traffic Control.

\*Bridge Man will perform work as per the October 31, 1949, memorandum on concrete forms, by and between the United Brotherhood of Carpenters and Joiners of America and the Laborers' International

# Prevailing Wage Rate

## Skilled Crafts

Union of North America, which states in; "the moving, cleaning, oiling and carrying to the next point of erection, and the stripping of forms which are not to be re-used, and forms on all flat arch work shall be done by members of the Laborers' International Union of North America."

### Group 2

Asphalt Raker, Screwman or Paver, Concrete Puddler, Kettle Man (pipeline), All Machine-Driven Tools (Gas, Electric, Air), Mason Tender, Brick Paver, Mortar Mixer, Skid Steer, Sheeting & Shoring Person, Surface Grinder Person, Screedperson, Water Blast, Hand Held Wand, Power Buggy or Power Wheelbarrow, Paint Striper, Plastic fusing Machine Operator, Rodding Machine Operator, Pug Mill Operator, Operator of All Vacuum Devices Wet or Dry, Handling of all Pumps 4 inches and under (gas, air or electric), Diver, Form Setter, Bottom Person, Welder Helper (pipeline), Concrete Saw Person, Cutting with Burning Torch, Pipe Layer, Hand Spiker (railroad), Underground Person (working in sewer and waterline, cleaning, repairing and reconditioning). Tunnel Laborer (without air), Caisson, Cofferdam (below 25 feet deep), Air Track and Wagon Drill, Sandblaster Nozzle Person, Hazardous Waste (level B), \*\*\*Lead Abatement, Hazardous Waste (level C)

\*\*\*Includes the erecting of structures for the removal, including the encapsulation and containment of Lead abatement process.

### Group 3

Blast and Powder Person, Muckers will be defined as shovel men working directly with the miners, Wrencher (mechanical joints & utility pipeline), Yarner, Top Lander, Hazardous Waste (level A), Concrete Specialist, Curb Setter and Cutter, Grade Checker, Concrete Crew in Tunnels. Utility pipeline Tappers, Waterline, Caulker, Signal Person will receive the rate equal to the rate paid the Laborer classification for which the Laborer is signaling.

### Group 4

Miner, Welder, Gunitite Nozzle Person

A.) The Watchperson shall be responsible to patrol and maintain a safe traffic zone including but not limited to barrels, cones, signs, arrow boards, message boards etc. The responsibility of a watchperson is to see that the equipment, job and office trailer etc. are secure.

# Prevailing Wage Rate Skilled Crafts

Name of Union: **Labor Local 1410 Building**

Change # : LCN01-2023ibLoc1410

Craft : **Laborer** Effective Date : 04/05/2023 Last Posted : 04/05/2023

	BHR		Fringe Benefit Payments						Irrevocable Fund		Total PWR	Overtime Rate
			H&W	Pension	App Tr.	Vac.	Annuity	Other	LECET (*)	MISC (*)		
Classification												
Laborer Group 1	\$30.35		\$8.20	\$4.05	\$0.40	\$0.00	\$0.00	\$0.00	\$0.10	\$0.00	\$43.10	\$58.28
Group 2	\$30.95		\$8.20	\$4.05	\$0.40	\$0.00	\$0.00	\$0.00	\$0.10	\$0.00	\$43.70	\$59.17
Group 3	\$31.45		\$8.20	\$4.05	\$0.40	\$0.00	\$0.00	\$0.00	\$0.10	\$0.00	\$44.20	\$59.92
Apprentice												
Apprentice	Percent											
Building Laborer 1-1000 hrs	60.00	\$18.21	\$8.20	\$4.05	\$0.40	\$0.00	\$0.00	\$0.00	\$0.10	\$0.00	\$30.96	\$40.07
1001-2000	70.02	\$21.25	\$8.20	\$4.05	\$0.40	\$0.00	\$0.00	\$0.00	\$0.10	\$0.00	\$34.00	\$44.63
2001-3000	80.00	\$24.28	\$8.20	\$4.05	\$0.40	\$0.00	\$0.00	\$0.00	\$0.10	\$0.00	\$37.03	\$49.17
3001-4000	89.99	\$27.31	\$8.20	\$4.05	\$0.40	\$0.00	\$0.00	\$0.00	\$0.10	\$0.00	\$40.06	\$53.72
More than 4000 hrs	100.00	\$30.35	\$8.20	\$4.05	\$0.40	\$0.00	\$0.00	\$0.00	\$0.10	\$0.00	\$43.10	\$58.28

**Special Calculation Note** : \$0.10 LECET is for Labor Management.

**Ratio :**

1 Journeymen to 1 Apprentice  
4 Journeymen to 1 Apprentice

**Jurisdiction ( \* denotes special jurisdictional note ) :**

LOGAN

**Special Jurisdictional Note :**

**Details :**

**Group 1**

Building & Construction Laborer, Railroad Laborer, Asbestos & Hazardous Waste (Levels A,B,C, & D), Concrete Crew, Form Setter, Pipelayer, Bottom Man, Burner (Cutting Torch), Welder Helper, All Machine & Power Driven Tools, Sandblaster Yardman-Landscaping, Sewer Jet, Waterperson, Tool Cage Laborer, Unloading Furniture & Fixtures, Final Clean-Up, Watchman, Residential Construction, Signal Men

**Group 2**

Mason Tender For Bricklayers, Flexcore, Firebrick Tender (Blast Furnaces, Soaking Pits, Stoves & Stacks), Plasterer Tenders & Lathers

**Group 3**

Tender Operator

Asbestos, Lead and Hazardous Material:

The removal, abatement or encapsulation of asbestos, lead and/or toxic and hazardous waste or materials



# **Prevailing Wage Rate**

## **Skilled Crafts**

is defined as all work included in the erection, moving servicing and dismantling of all enclosures, scaffolding, barricades, etc. and the operation of all tools and equipment (including generators, compressors and vacuums) normally used in the removal or abatement of asbestos, lead and toxic and hazardous waste or materials; the labeling, bagging, cartoning, crating or otherwise packaging of materials for disposal; as well as the clean-up of the work site and all other work incidental to the removal, abatement or encapsulation of asbestos, lead or toxic and hazardous waste materials.

### **Level A**

Protective equipment is required when the area has been determined to contain extremely toxic contaminants or contaminants unknown but may be expected to be extremely toxic and/or immediately dangerous to life and health. This ensemble includes a fully encapsulated chemical suit, self contained breathing apparatus (SCBA) or airline fed respirator, and various types and numbers of boots and gloves.

### **Level B**

Protective equipment includes a chemically resistant splash suit and a SCBA or airline respirator. This ensemble is required when the situation is very hazardous, such as oxygen deficient atmospheres, IDLH atmospheres, or confined space entries.

### **Level C**

Protective equipment includes a protective suit and an air purifying respirator (APR) with the appropriate filter canisters.

### **Level D**

To be worn only in established "safe zones" may consist of, from normal work clothes to normal skin protection such as gloves, face shields goggles, coveralls and occasionally respiratory protection.

# Prevailing Wage Rate Skilled Crafts

Name of Union: **Operating Engineers - Building Local 18 - Zone III**

Change # : LCN01-2023ibLoc18zone3

Craft : **Operating Engineer Effective Date : 05/01/2023 Last Posted : 04/26/2023**

	BHR		Fringe Benefit Payments						Irrevocable Fund		Total PWR	Overtime Rate
			H&W	Pension	App Tr.	Vac.	Annuity	Other	LECET (*)	MISC (*)		
Classification												
Operator Group A	\$41.49		\$9.01	\$6.25	\$0.85	\$0.00	\$0.00	\$0.09	\$0.00	\$0.05	\$57.74	\$78.48
Operator Group B	\$41.37		\$9.01	\$6.25	\$0.85	\$0.00	\$0.00	\$0.09	\$0.00	\$0.05	\$57.62	\$78.30
Operator Group C	\$40.33		\$9.01	\$6.25	\$0.85	\$0.00	\$0.00	\$0.09	\$0.00	\$0.05	\$56.58	\$76.74
Operator Group D	\$39.15		\$9.01	\$6.25	\$0.85	\$0.00	\$0.00	\$0.09	\$0.00	\$0.05	\$55.40	\$74.97
Operator Group E	\$33.69		\$9.01	\$6.25	\$0.85	\$0.00	\$0.00	\$0.09	\$0.00	\$0.05	\$49.94	\$66.78
Master Mechanic	\$41.74		\$9.01	\$6.25	\$0.85	\$0.00	\$0.00	\$0.09	\$0.00	\$0.05	\$57.99	\$78.86
Cranes & Mobile Concrete Pumps 150'-180'	\$41.99		\$9.01	\$6.25	\$0.85	\$0.00	\$0.00	\$0.09	\$0.00	\$0.05	\$58.24	\$79.23
Cranes & Mobile Concrete Pumps 180'-249'	\$42.49		\$9.01	\$6.25	\$0.85	\$0.00	\$0.00	\$0.09	\$0.00	\$0.05	\$58.74	\$79.98
Cranes & Mobile Concrete Pumps 249' and over	\$42.74		\$9.01	\$6.25	\$0.85	\$0.00	\$0.00	\$0.09	\$0.00	\$0.05	\$58.99	\$80.36
Apprentice		Percent										
1st Year	50.00	\$20.75	\$9.01	\$6.25	\$0.85	\$0.00	\$0.00	\$0.09	\$0.00	\$0.05	\$37.00	\$47.37
2nd Year	60.00	\$24.89	\$9.01	\$6.25	\$0.85	\$0.00	\$0.00	\$0.09	\$0.00	\$0.05	\$41.14	\$53.59
3rd Year	70.00	\$29.04	\$9.01	\$6.25	\$0.85	\$0.00	\$0.00	\$0.09	\$0.00	\$0.05	\$45.29	\$59.81
4th Year	80.00	\$33.19	\$9.01	\$6.25	\$0.85	\$0.00	\$0.00	\$0.09	\$0.00	\$0.05	\$49.44	\$66.04
Field Mechanic Trainee												
1st Year	50.00	\$20.75	\$9.01	\$6.25	\$0.85	\$0.00	\$0.00	\$0.09	\$0.00	\$0.05	\$37.00	\$47.37
2nd Year	60.00	\$24.89	\$9.01	\$6.25	\$0.85	\$0.00	\$0.00	\$0.09	\$0.00	\$0.05	\$41.14	\$53.59
3rd Year	70.00	\$29.04	\$9.01	\$6.25	\$0.85	\$0.00	\$0.00	\$0.09	\$0.00	\$0.05	\$45.29	\$59.81
4th Year	80.00	\$33.19	\$9.01	\$6.25	\$0.85	\$0.00	\$0.00	\$0.09	\$0.00	\$0.05	\$49.44	\$66.04

**Special Calculation Note :** Other: Education & Safety \$0.09; \*Misc is National Training

**Ratio:**

For every (3) Operating Engineer Journeymen employed by the company there may be employed (1) Registered Apprentice or trainee Engineer through the referral when they are available. An apprentice, while employed as part of a crew per Article VIII, paragraph 78, will not be subject to the apprenticeship ratios in this collective bargaining agreement

**Jurisdiction ( \*denotes special jurisdictional note):**

LOGAN

# Prevailing Wage Rate

## Skilled Crafts

### Special Jurisdictional Note :

#### Details :

Note: There will be a 10% increase for the apprentices on top of the percentages listed above provided they are operating mobile equipment. Mechanic Trainees will receive 10% increase if required to have CDL

**Group A-** Barrier Moving Machines; Boiler Operators or Compressor Operators, when compressor or boiler is mounted on crane (Piggyback Operation); Boom Trucks (all types); Cableways Cherry Pickers; Combination - Concrete Mixers & Towers; All Concrete Pumps with Booms; Cranes (all types); Compact Cranes, track or rubber over 4,000 pounds capacity; Cranes self-erecting, stationary, track or truck (all configurations); Derricks (all types); Draglines; Dredges (dipper, clam or suction) 3-man crew; Elevating Graders or Euclid Loaders; Floating Equipment; Forklift (rough terrain with winch/hoist); Gradalls; Helicopter Operators, hoisting building materials; Helicopter Winch Operators, Hoisting building materials; Hoes (All types); Hoists (with two or more drums in use); Horizontal Directional Drill; Hydraulic Gantry (lift system); Laser Finishing Machines; Laser Screed and like equipment; Lift Slab or Panel Jack Operators; Locomotives (all types); Maintenance Operator/Technician(Mechanic Operator/Technician and/or Welder); Mixers, paving (multiple drum); Mobile Concrete Pumps, with booms; Panelboards, (all types on site); Pile Drivers; Power Shovels; Prentice Loader; Rail Tamper (with automatic lifting and aligning device); Rotary Drills (all), used on caissons for foundations and sub-structure; Side Booms; Slip Form Pavers; Straddle Carriers (Building Construction on site); Trench Machines (over 24" wide); Tug Boats.

**Group B** - Articulating/end dumps (minus \$4.00/hour from Group B rate); Asphalt Pavers; Bobcat-type and/or skid steer loader with hoe attachment greater than 7000 lbs.; Bulldozers; CMI type Equipment; Concrete Saw, Vermeer-type; Endloaders; Hydro Milling Machine; Kolman-type Loaders (Dirt Loading); Lead Greasemen; Mucking Machines; Pettibone-Rail Equipment; Power Graders; Power Scoops; Power Scrapers; Push Cats; Rotomills (all), grinders and planers of all types.

**Group C** - A-Frames; Air Compressors, Pressurizing Shafts or Tunnels; All Asphalt Rollers; Bobcat-type and/or Skid Steer Loader with or without attachments; Boilers (15 lbs. pressure and over); All Concrete Pumps (without booms with 5 inch system); Fork Lifts (except masonry); Highway Drills - all types (with integral power); Hoists (with one drum); House Elevators (except those automatic call button controlled), Buck Hoists, Transport Platforms, Construction Elevators; Hydro Vac/Excavator (when a second person is needed, the rate of pay will be "Class E"); Man Lifts; Material hoist/elevators; Mud Jacks; Pressure Grouting; Pump Operators (installing or operating Well Points or other types of Dewatering Systems); Pumps (4 inches and over discharge); Railroad Tie (Inserter/Remover); Rotovator (Lime-Soil Stabilizer); Submersible Pumps (4"and over discharge); Switch & Tie Tampers (without lifting and aligning device); Trench Machines (24" and under); Utility Operators.

**Group D** - Backfillers and Tampers; Ballast Re-locator; Batch Plant Operators; Bar and Joint Installing Machines; Bull Floats; Burlap and Curing Machines; Clefplanes; Compressors, on building construction; Concrete Mixers, more than one bag capacity; Concrete Mixers, one bag capacity (side loaders); All Concrete Pumps (without boom with 4" or smaller system); Concrete Spreader; Conveyors, used for handling building materials; Crushers; Deckhands; Drum Fireman (in asphalt plants); Farm type tractors pulling attachments; Finishing Machines; Form Trenchers; Generators; Gunite Machines; Hydro-seeders; Pavement Breakers (hydraulic or cable); Post Drivers; Post Hole Diggers; Pressure Pumps (over 1/2") discharge); Road Widening Trenchers; Rollers (except asphalt); Self-propelled sub-graders; Shotcrete Machines; Tire Repairmen; Tractors, pulling sheepsfoot post roller or grader; VAC/ALLS; Vibratory Compactors, with integral power; Welders.

**Group E** – Allen Screed Paver (concrete); Boilers (less than 15 lbs. pressure); Cranes-Compact, track or rubber (under 4,000 pounds capacity); Directional Drill "Locator"; Fueling and greasing +\$3.00; Inboard/outboard Motor Boat Launches; Light Plant Operators; Masonry Fork Lifts; Oilers/Helpers; Power Driven Heaters (oil fired); Power Scrubbers; Power Sweepers; Pumps (under 4 inch discharge); Signalperson, Submersible Pumps (under 4" discharge).

Master Mechanics - Master Mechanic

Cranes 150' – 180' - Boom & Jib 150 - 180 feet

Cranes 180' – 249' - Boom & Jib 180 - 249 feet

Cranes 250' and over - Boom & Jib 250-feet or over

# Prevailing Wage Rate Skilled Crafts

Name of Union: **Operating Engineers - HevHwy Zone II**

Change # : LCN01-2023ibLoc18hevhwyl

Craft : **Operating Engineer** Effective Date : 05/01/2023 Last Posted : 04/26/2023

	BHR		Fringe Benefit Payments					Irrevocable Fund		Total PWR	Overtime Rate	
			H&W	Pension	App Tr.	Vac.	Annuity	Other	LECET (*)			MISC (*)
Classification												
Operator Class A	\$41.49		\$9.01	\$6.25	\$0.85	\$0.00	\$0.00	\$0.09	\$0.00	\$0.05	\$57.74	\$78.48
Operator Class B	\$41.37		\$9.01	\$6.25	\$0.85	\$0.00	\$0.00	\$0.09	\$0.00	\$0.05	\$57.62	\$78.30
Operator Class C	\$40.33		\$9.01	\$6.25	\$0.85	\$0.00	\$0.00	\$0.09	\$0.00	\$0.05	\$56.58	\$76.74
Operator Class D	\$39.15		\$9.01	\$6.25	\$0.85	\$0.00	\$0.00	\$0.09	\$0.00	\$0.05	\$55.40	\$74.97
Operator Class E	\$33.69		\$9.01	\$6.25	\$0.85	\$0.00	\$0.00	\$0.09	\$0.00	\$0.05	\$49.94	\$66.78
Master Mechanic	\$41.74		\$9.01	\$6.25	\$0.85	\$0.00	\$0.00	\$0.09	\$0.00	\$0.05	\$57.99	\$78.86
Apprentice												
Percent												
1st Year	50.00	\$20.75	\$9.01	\$6.25	\$0.85	\$0.00	\$0.00	\$0.09	\$0.00	\$0.05	\$37.00	\$47.37
2nd Year	60.00	\$24.89	\$9.01	\$6.25	\$0.85	\$0.00	\$0.00	\$0.09	\$0.00	\$0.05	\$41.14	\$53.59
3rd Year	70.00	\$29.04	\$9.01	\$6.25	\$0.85	\$0.00	\$0.00	\$0.09	\$0.00	\$0.05	\$45.29	\$59.81
4th Year	80.00	\$33.19	\$9.01	\$6.25	\$0.85	\$0.00	\$0.00	\$0.09	\$0.00	\$0.05	\$49.44	\$66.04
Field Mech Trainee Class 2												
1st year	50.00	\$20.75	\$9.01	\$6.25	\$0.85	\$0.00	\$0.00	\$0.09	\$0.00	\$0.05	\$37.00	\$47.37
2nd year	60.00	\$24.89	\$9.01	\$6.25	\$0.85	\$0.00	\$0.00	\$0.09	\$0.00	\$0.05	\$41.14	\$53.59
3rd year	70.00	\$29.04	\$9.01	\$6.25	\$0.85	\$0.00	\$0.00	\$0.09	\$0.00	\$0.05	\$45.29	\$59.81
4th year	80.00	\$33.19	\$9.01	\$6.25	\$0.85	\$0.00	\$0.00	\$0.09	\$0.00	\$0.05	\$49.44	\$66.04

**Special Calculation Note :** Other: Education & Safety Fund is \$0.09 per hour. \*Misc is National Training

**Ratio :**

For every (3) Operating Engineer Journeymen employed by the company, there may be employed (1) Registered Apprentice or Trainee Engineer through the referral when they are available. An Apprentice, while employed as part of a crew per Article VIII, paragraph 65 will not be subject to the apprenticeship ratios in this collective bargaining agreement

**Jurisdiction ( \* denotes special jurisdictional note ) :**

LOGAN

**Special Jurisdictional Note :**

**Details :**

\*\*Apprentices will receive a 10% increase on top of the percentages listed above provided they are operating mobile equipment. Mechanic Trainees will receive 10% increase if they are required to have CDL.

# Prevailing Wage Rate

## Skilled Crafts

**Class A** - Air Compressors on Steel Erection; Asphalt Plant Engineers (Cleveland District Only); Barrier Moving Machine; Boiler Operators, Compressor Operators, or Generators, when mounted on a rig; Boom Trucks (all types); Cableways; Cherry Pickers; Combination- Concrete Mixers & Towers; Concrete Plants (over 4 yd capacity); Concrete Pumps; Cranes (all types); Compact Cranes track or rubber over 4,000 pounds capacity; Cranes self-erecting stationary, track or truck; Derricks (all types); Draglines; Dredges dipper, clam or suction; Elevating Graders or Euclid Loaders; Floating Equipment (all types); Gradalls; Helicopter Crew (Operator- hoist or winch); Hoes (all types); Hoisting Engines; Hoisting Engines, on shaft or tunnel work; Hydraulic Gantry (lifting system); Industrial-type Tractors; Jet Engine Dryer (D8 or D9) diesel Tractors; Locomotives (standard gauge); Maintenance Operators/Technicians (class A); Mixers, paving (single or double drum); Mucking Machines; Multiple Scrapers; Piledriving Machines (all types); Power Shovels, Prentice Loader; Quad 9 (double pusher); Rail Tamper (with automatic lifting and aligning device); Refrigerating Machines (freezer operation); Rotary Drills, on caisson work; Rough Terrain Fork Lift with winch/hoist; Side Booms; Slip Form Pavers; Survey Crew Party Chiefs; Tower Derricks; Tree Shredders; Trench Machines (over 24" wide); Truck Mounted Concrete Pumps; Tug Boats; Tunnel Machines and /or Mining Machines; Wheel Excavators.

**Class B** - Asphalt Pavers; Automatic Subgrade Machines, self-propelled (CMI-type); Bobcat-type and /or Skid Steer Loader with hoe attachment greater than 7000 lbs.; Boring Machine Operators (more than 48 inches); Bulldozers; Concrete Saws, Vermeer type; Endloaders; Horizontal Directional Drill (50,000 ft. lbs. thrust and over); Hydro Milling Machine; Kolman-type Loaders (production type-dirt); Lead Greasemen; Lighting and Traffic Signal Installation Equipment includes all groups or classifications; Maintenance Operators/Technicians, Class B; Material Transfer Equipment (shuttle buggy) Asphalt; Pettibone-Rail Equipment; Power Graders; Power Scrapers; Push Cats; Rotomills (all), Grinders and Planners of all types, Groovers (excluding walk-behinds); Trench Machines (24 inch wide and under).

**Class C** - A-Frames; Air Compressors, on tunnel work (low Pressure); Articulating/straight bed end dumps if assigned (minus \$4.00 per hour); Asphalt Plant Engineers (Portage and Summit Counties only); Bobcat-type and/or skid steer loader with or without attachments; Drones; Highway Drills (all types); HydroVac/Excavator (when a second person is needed, the rate of pay will be "Class E"); Locomotives (narrow gauge); Material Hoist/Elevators; Mixers, concrete (more than one bag capacity); Mixers, one bag capacity (side loader); Power Boilers (over 15 lbs. pressure); Pump Operators (installing or operating well Points); Pumps (4 inch and over discharge); Railroad Tie Inserter/Remover; Rollers, Asphalt; Rotovator (lime-soil Stabilizer); Switch & Tie Tampers (without lifting and aligning device); Utilities Operators, (small equipment); Welding Machines and Generators.

**Class D** – Backfillers and Tampers; Ballast Re-locator; Bar and Joint Installing Machines; Batch Plant Operators; Boring Machine Operators (48 inch or less); Bull Floats; Burlap and Curing Machines; Concrete Plants (capacity 4 yds. and under); Concrete Saws (multiple); Conveyors (highway); Crushers; Deckhands; Farm type tractors, with attachments (highway); Finishing Machines; Firemen, Floating Equipment (all types); Fork Lifts (highway), except masonry; Form Trenchers; Hydro Hammers; Hydro Seeders; Pavement Breakers (hydraulic or cable); Plant Mixers; Post Drivers; Post Hole Diggers; Power Brush Burners; Power Form Handling Equipment; Road Widening Trenchers; Rollers (brick, grade, macadam); Self-Propelled Power Spreaders; Self-Propelled Sub-Graders; Steam Firemen; Survey Instrument men; Tractors, pulling sheepsfoot rollers or graders; Vibratory Compactors, with integral power.

**Class E** - Compressors (portable, Sewer, Heavy and Highway); Cranes-Compact, track or rubber under 4,000 pound capacity; Drum Firemen (asphalt plant); Fueling and greasing (Primary Operator with Specialized CDL Endorsement Add \$3.00/hr); Generators; Inboard-Outboard Motor Boat Launches; Masonry Fork Lifts; Oil Heaters (asphalt plant); Oilers/Helpers; Power Driven Heaters (oil fired); Power Scrubbers; Power Sweepers; Pumps (under 4 inch discharge); Signalperson; Survey Rodmen or Chairmen; Tire Repairmen; VAC/ALLS. Master Mechanic - Master Mechanic

# Prevailing Wage Rate Skilled Crafts

Name of Union: **Truck Driver Bldg & HevHwy Class 1**  
Locals 20,40,92,92b,100,175,284,438,377,637,908,957

Change # : LCN01-2023ibBldgHevHwy

Craft : **Truck Driver** Effective Date : **05/01/2023** Last Posted : **04/26/2023**

	BHR		Fringe Benefit Payments						Irrevocable Fund		Total PWR	Overtime Rate
			H&W	Pension	App Tr.	Vac.	Annuity	Other	LECET (*)	MISC (*)		
<b>Classification</b>												
Truck Driver CLASS 1 4 wheel service, dump, and batch trucks; drivers on tandems; truck sweepers (not to include power sweepers & scrubbers)	\$31.24		\$7.75	\$9.20	\$0.20	\$0.00	\$0.00	\$0.00	\$0.00	\$0.00	\$48.39	\$64.01
<b>Apprentice</b>												
	<b>Percent</b>											
First 6 months	80.00	\$24.99	\$7.75	\$9.20	\$0.20	\$0.00	\$0.00	\$0.00	\$0.00	\$0.00	\$42.14	\$54.64
7-12 months	85.00	\$26.55	\$7.75	\$9.20	\$0.20	\$0.00	\$0.00	\$0.00	\$0.00	\$0.00	\$43.70	\$56.98
13-18 months	90.00	\$28.12	\$7.75	\$9.20	\$0.20	\$0.00	\$0.00	\$0.00	\$0.00	\$0.00	\$45.27	\$59.32
19-24 months	95.00	\$29.68	\$7.75	\$9.20	\$0.20	\$0.00	\$0.00	\$0.00	\$0.00	\$0.00	\$46.83	\$61.67
25-30 months	100.00	\$31.24	\$7.75	\$9.20	\$0.20	\$0.00	\$0.00	\$0.00	\$0.00	\$0.00	\$48.39	\$64.01

**Special Calculation Note :** No special calculations for this skilled craft wage rate are required at this time.

**Ratio :**  
3 Journeymen to 1 Apprentice

**Jurisdiction ( \* denotes special jurisdictional note ) :**  
LOGAN

**Special Jurisdictional Note :**

**Details :**

# Prevailing Wage Rate Skilled Crafts

Name of Union: **Truck Driver Bldg & HevHwy Class 3**  
Locals 20,40,92,92b,100,175,284,438,377,637,908,957

Change # : LCN01-2023ibBldgHevHwy3

Craft : **Truck Driver** Effective Date : **05/01/2023** Last Posted : **04/26/2023**

	BHR		Fringe Benefit Payments						Irrevocable Fund		Total PWR	Overtime Rate
			H&W	Pension	App Tr.	Vac.	Annuity	Other	LECET (*)	MISC (*)		
Classification												
Truck Driver CLASS 3 Articulated Dump Trucks; Ridge-Frame Rock Trucks; Distributor Trucks)	\$32.66	\$7.75	\$9.20	\$0.20	\$0.00	\$0.00	\$0.00	\$0.00	\$0.00	\$0.00	\$49.81	\$66.14
Apprentice	Percent											
First 6 months	80.00	\$26.13	\$7.75	\$9.20	\$0.20	\$0.00	\$0.00	\$0.00	\$0.00	\$0.00	\$43.28	\$56.34
7-12 months	85.00	\$27.76	\$7.75	\$9.20	\$0.20	\$0.00	\$0.00	\$0.00	\$0.00	\$0.00	\$44.91	\$58.79
13-18 months	90.00	\$29.39	\$7.75	\$9.20	\$0.20	\$0.00	\$0.00	\$0.00	\$0.00	\$0.00	\$46.54	\$61.24
19-24 months	95.00	\$31.03	\$7.75	\$9.20	\$0.20	\$0.00	\$0.00	\$0.00	\$0.00	\$0.00	\$48.18	\$63.69
25-30 months	100.00	\$32.66	\$7.75	\$9.20	\$0.20	\$0.00	\$0.00	\$0.00	\$0.00	\$0.00	\$49.81	\$66.14

**Special Calculation Note :** No special calculations for this skilled craft wage rate are required at this time.

**Ratio :**  
3 Journeymen to 1 Apprentice

**Jurisdiction ( \* denotes special jurisdictional note ) :**  
LOGAN

**Special Jurisdictional Note :**

**Details :**